

# ELYSIA

OUTDOOR MODULAR KITCHEN BY **FONTANA**  
FORNI



## STORAGE

**Instruction Manual**

---

**Storage 90**

**Storage 65**



Introduction.....	1
Suggested Tools for Assembly.....	1
Product Dimensions.....	2
Parts List.....	3
Components List.....	4
Instructions.....	5
Adjustment.....	20
Cleaning and Maintenance.....	21

# BEFORE YOU START

## Welcome to your Elysia Outdoor Modular Kitchen

### Save these instructions.

- Read these instructions completely and carefully. Do not skip any step. Put all bolts used in a step before tighten them.
- Some parts have sharp edges, care must be taken to avoid injury. Please wear gloves when handling.
- Two or more people should work together to assemble the kitchen modules and FONTANA Appliances.
- During assembly, work on a protected surface to avoid damaging the pieces.

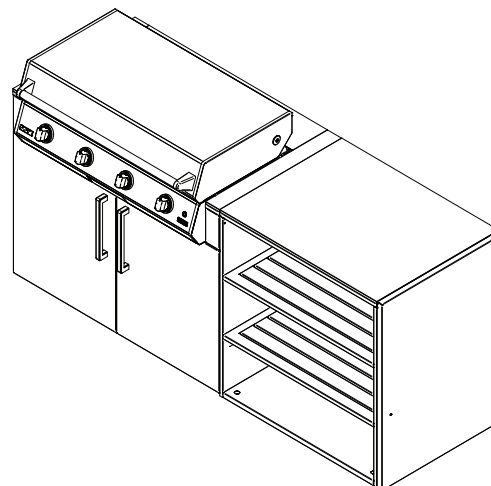

## SUGGESTED TOOLS FOR ASSEMBLY

1 - Phillips Head

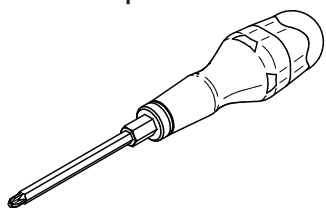

1 - Allen Wrench (CRV-4 Hex Head)

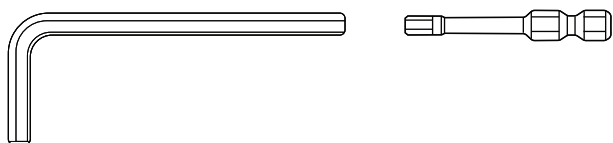

1 - Adjustable wrench  
(or 7mm nut driver bit)

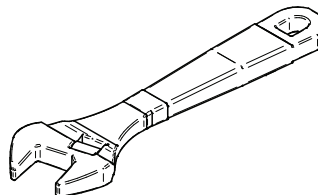

1 - Silicone Adhesive  
Suitable for Ceramics

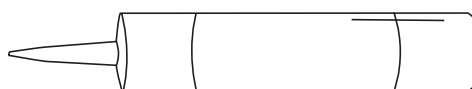

# PRODUCT DIMENSIONS

## Storage 90

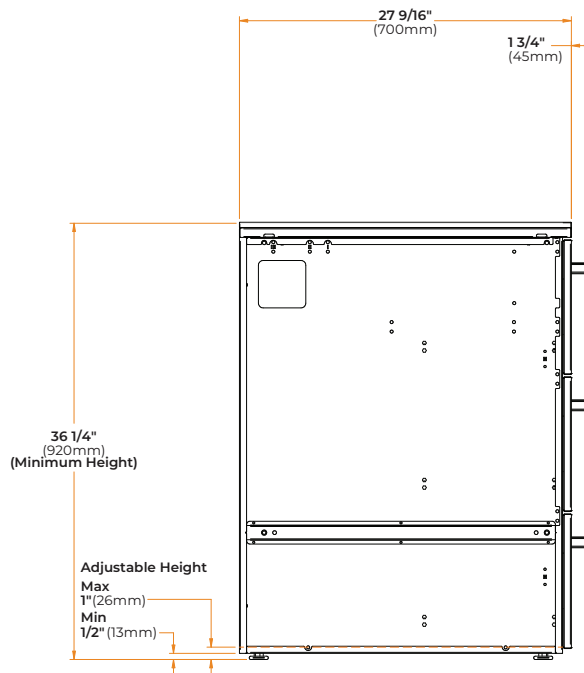
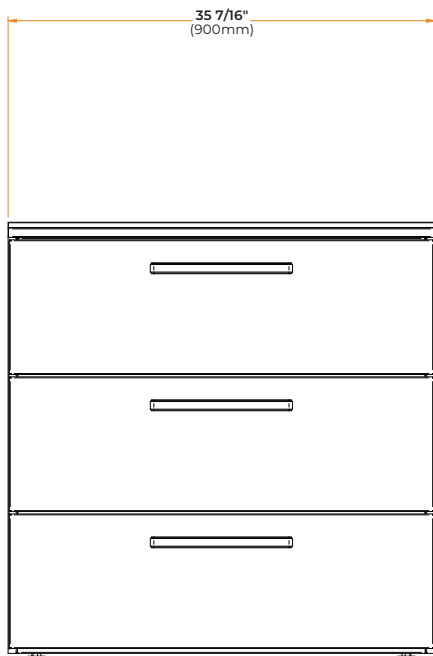

## Storage 65 (with Trash Drawers)

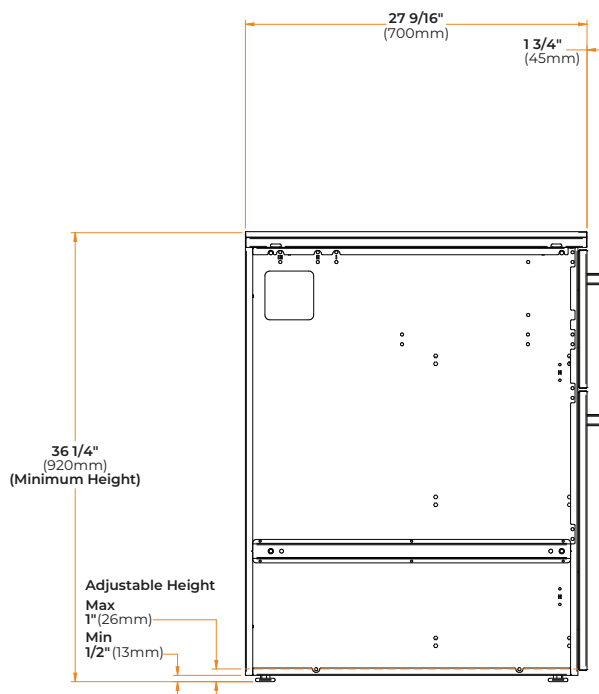
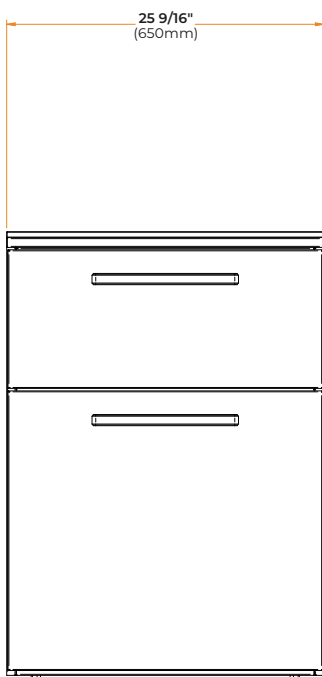

# PARTS LIST

## Storage 90

#	NAME	QTY
1	BASE	1
2	R-SIDE PANEL	1
3	L-SIDE PANEL	1
4	COUNTERTOP	1
5	REAR	1
6	RIB	3
7	STONE	1
8	DRAWER FRONT	3
9	DRAWER BOTTOM	3
10	DRAWER BACK	3

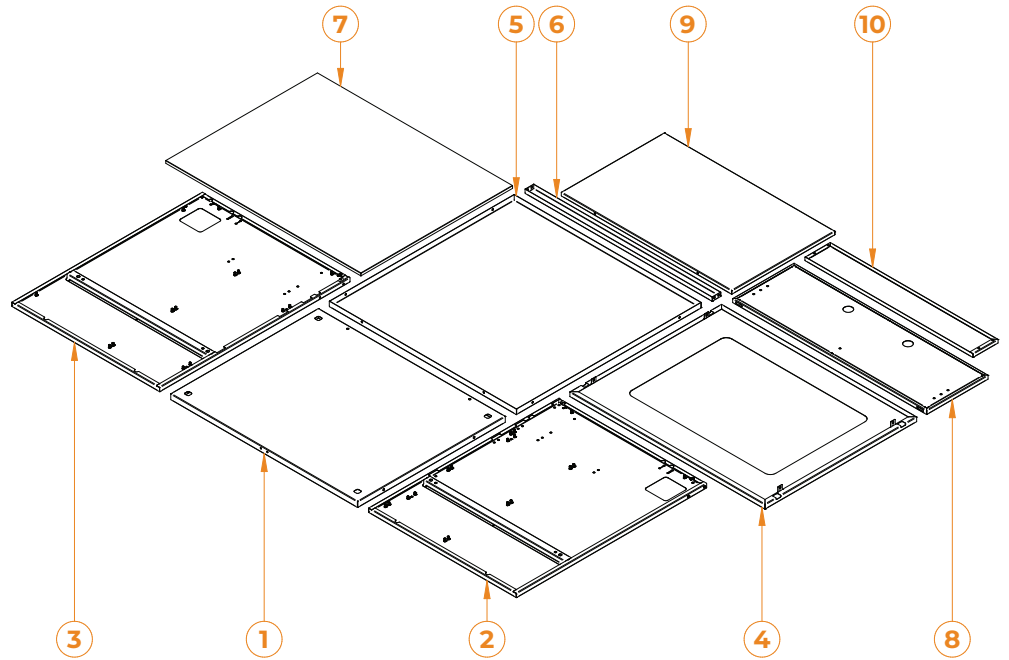

## Storage 65

#	NAME	QTY
1	BASE	1
2	R-SIDE PANEL	1
3	L-SIDE PANEL	1
4	COUNTERTOP	1
5	REAR	1
6	RIB	2
7	STONE	1
8U	UPPER DRAWER FRONT	1
8L	LOWER DRAWER FRONT	1
9	DRAWER BOTTOM	2
10	DRAWER BACK	2
11	BIN BOX TOP	1
12	BIN BOX L-SIDE	1
13	BIN BOX R-SIDE	1

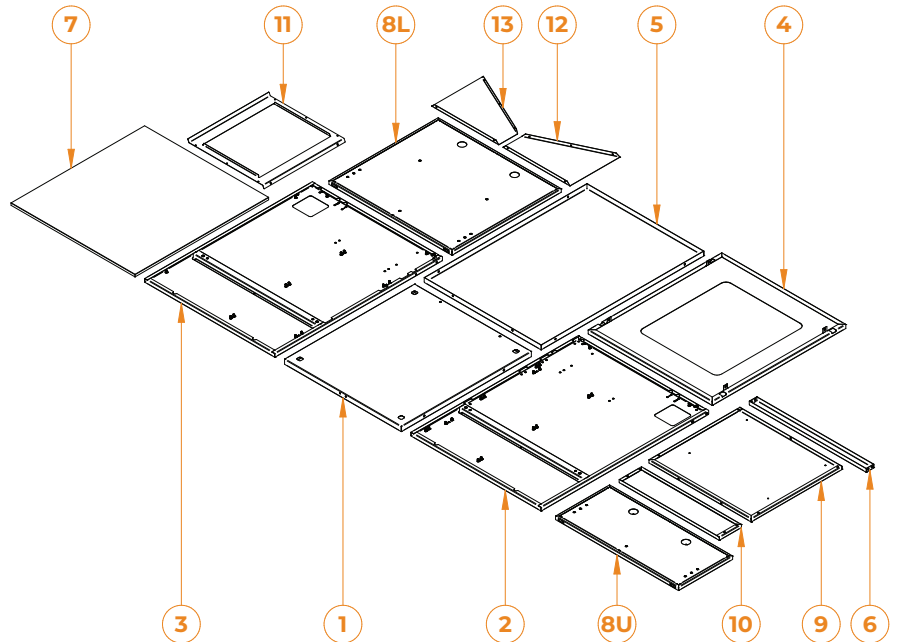

# COMPONENTS LIST

#	NAME	DRAWERS	TRASH DRAWERS
A	L-DRAWER SIDE	3	2
B	R-DRAWER SIDE	3	2
C	L-DRAWER SLIDE	3	2
D	R-DRAWER SLIDE	3	2
E	L-DRAWER CORNER	3	2
F	R-DRAWER CORNER	3	2
G	SIDE-FRONT FIX	6	4
H	DRAWER HANDLE	3	2
I	SCREW M4X12	6	4
J	SCREW M4X10 ROUNDHEAD	33	34
K	SCREW M5X12	50	38
L	SCREW M6X16 BUTTON HEAD	8	8
M	SPACER CYLINDER M6X35	4	4
N	ADJUSTABLE LEG	4	4
O	SCREW M4X16 COUNTERSUNK	18	12
P	M4 NUT	0	10

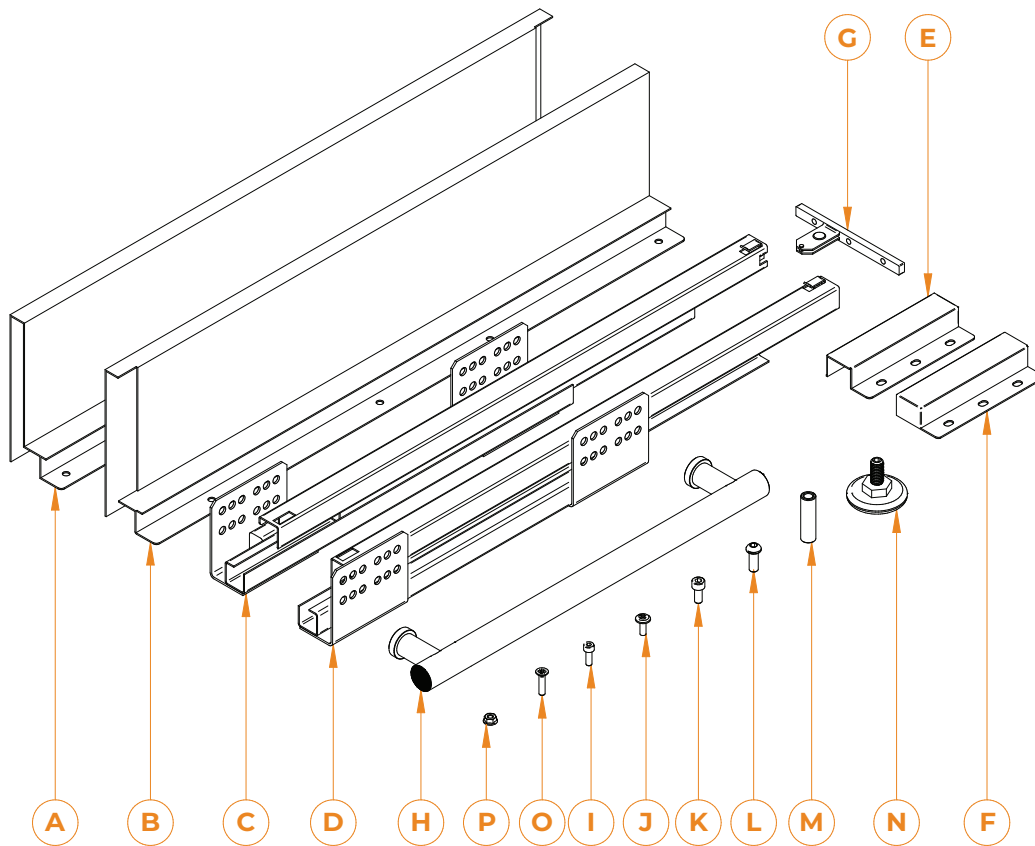

# INSTRUCTIONS

**Step 1** | Insert **Adjustable Legs (N - 4X)** in four corners of the **Base (1)**.

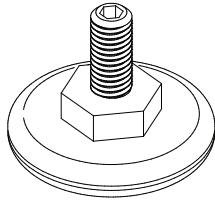

#	COMPONENT	QTY
N	ADJUSTABLE LEG	4

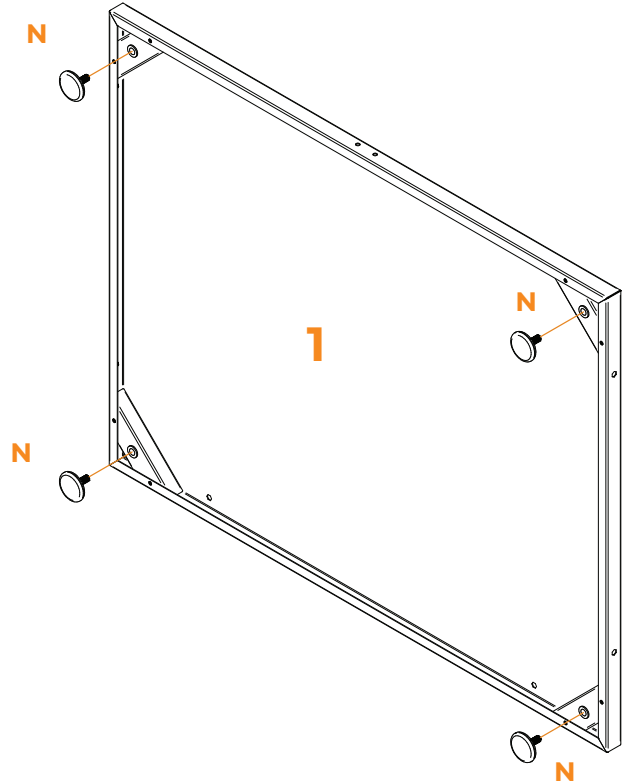

\* Example image: STORAGE 90

**Step 2** | Attach the **Rear (5)** to the **Base (1)** with **Screw M5x12 (K - 2X)**, secure with an allen wrench (or hex head).

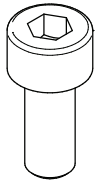

#	COMPONENT	QTY
K	SCREW M5X12	2

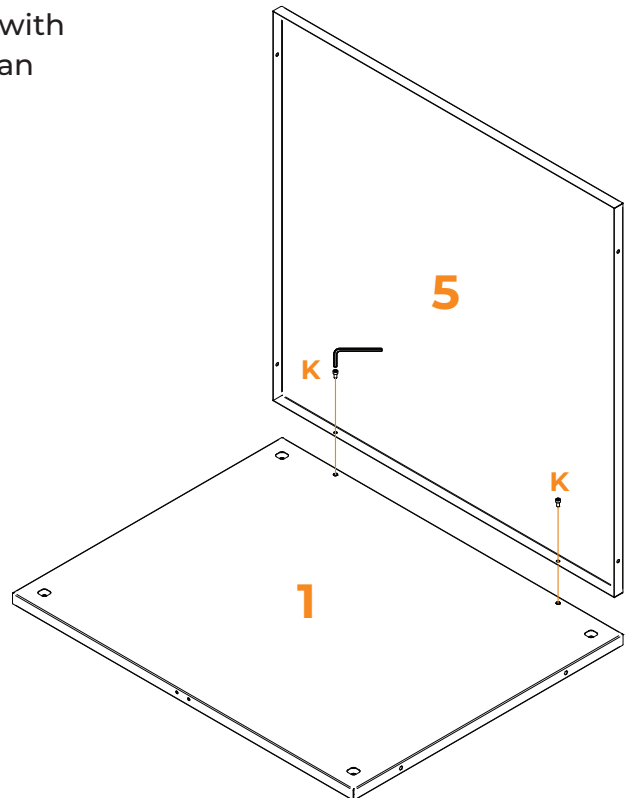

\* Example image: STORAGE 90

**Step 3** | Attach **L-Side Panel (3)** to **Base (1)** and **Rear (5)** with **Screw M5x12 (K - 4X)**, secure with an allen wrench (or hex head).

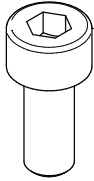

#	COMPONENT	QTY
K	SCREW M5X12	4

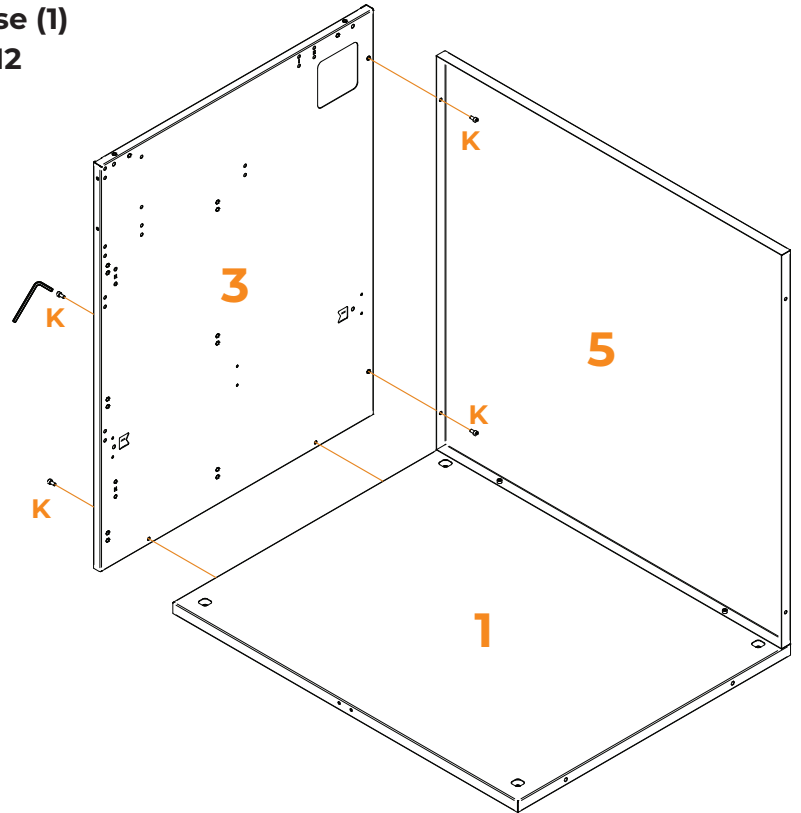

\* Example image: STORAGE 90

**Step 4** | Attach **R-Side Panel (2)** to **Base (1)** and **Rear (5)** with **Screw M5x12 (K - 4X)**, secure with an allen wrench (or hex head).

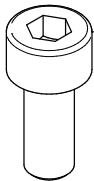

#	COMPONENT	QTY
K	SCREW M5X12	4

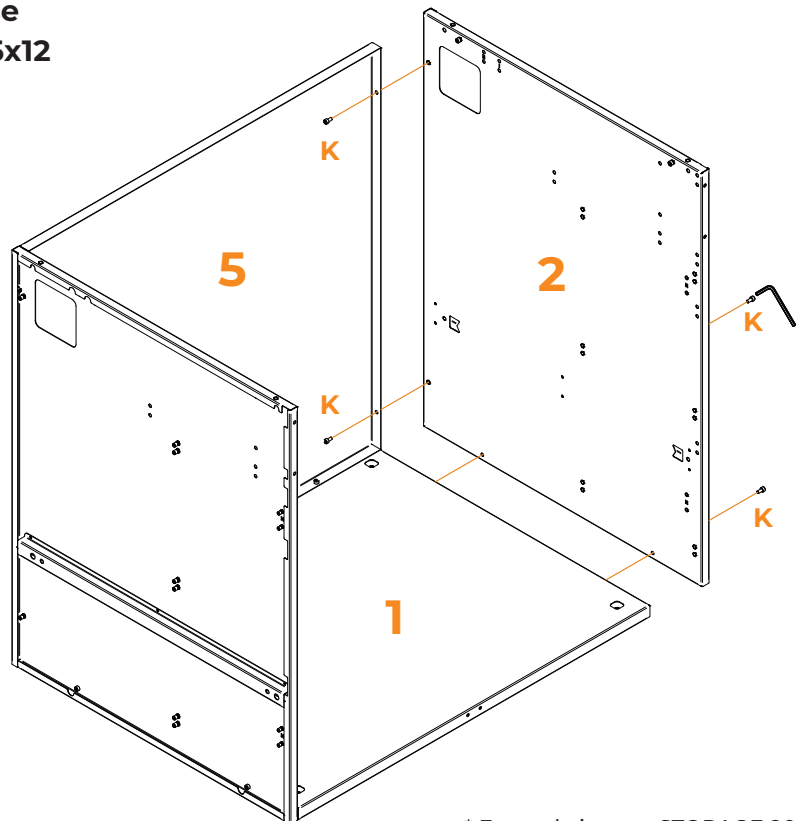

\* Example image: STORAGE 90

## Step 5 | FOR STORAGE 90 UNIT

**Attach Ribs (6 - 3X) to R-Side Panel (2) and L-Side Panel (3) with Screw M5x12 (K - 12X),** secure with an allen wrench (or hex head).

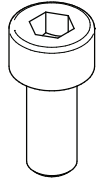

#	COMPONENT	QTY
K	SCREW M5X12	12

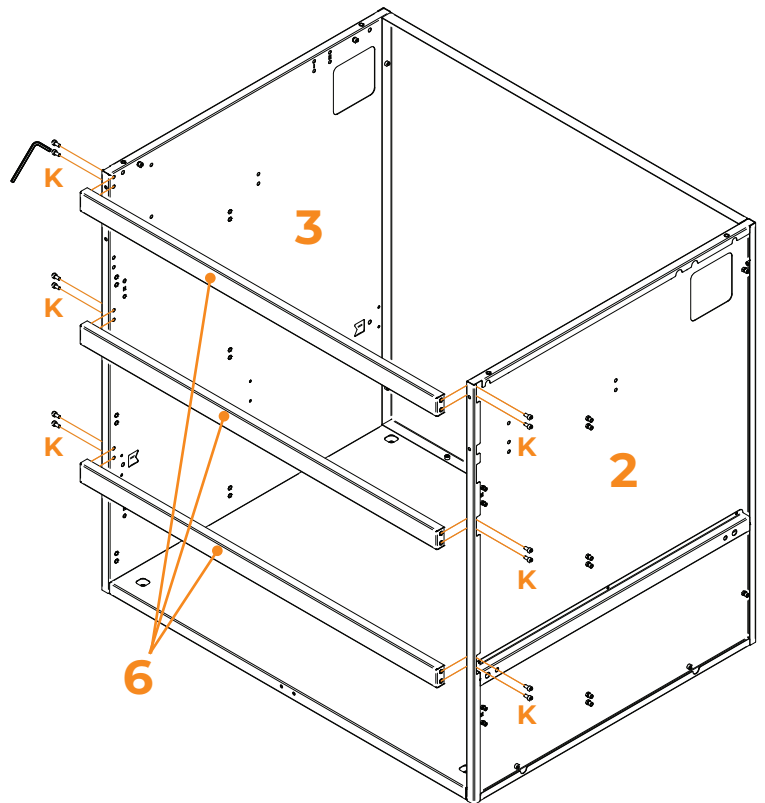

\* Example image: STORAGE 90

## Step 5 | FOR STORAGE 65 UNIT WITH TRASH DRAWER

**Attach Ribs (6 - 2X) to R-Side Panel (2) and L-Side Panel (3) with Screw M5x12 (K - 8X),** secure with an allen wrench (or hex head).

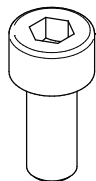

#	COMPONENT	QTY
K	SCREW M5X12	8

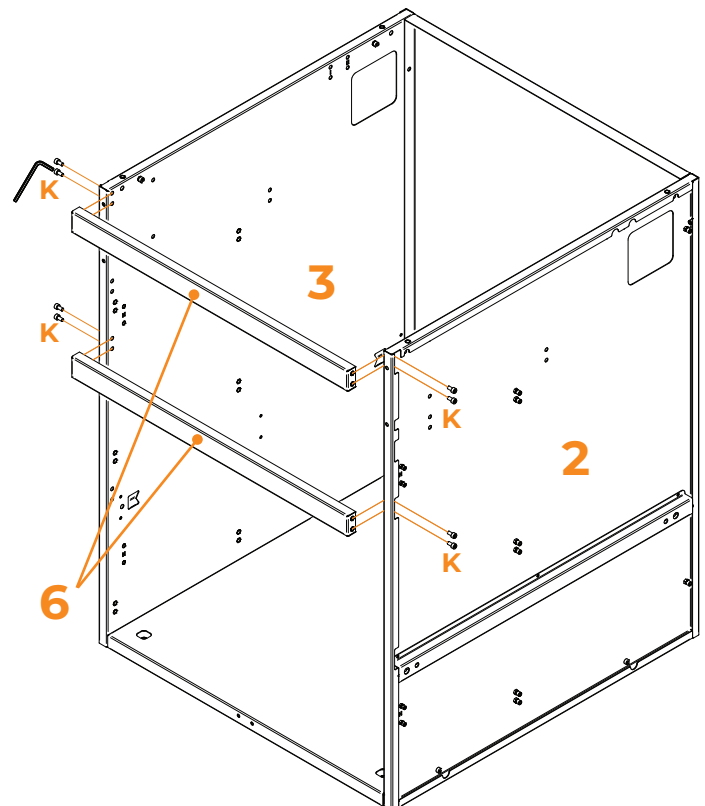

\* Example image: STORAGE 65

## Step 6 | FOR STORAGE 90 UNIT

Attach **L-Drawer Slide (C - 3X)** to **L-Side Panel (3)** and **R-Drawer Slide (D - 3X)** to **R-Side Panel (2)** with **Screw M5x12 (K - 24X)**, secure with an allen wrench (or hex head).

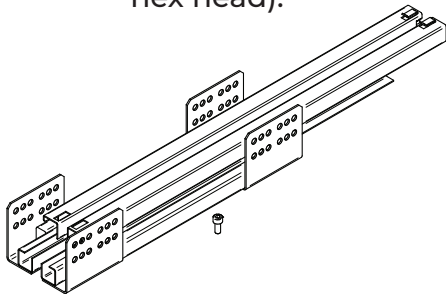

#	COMPONENT	QTY
K	SCREW M5X12	24
C	L-DRAWER SLIDE	3
D	R-DRAWER SLIDE	3

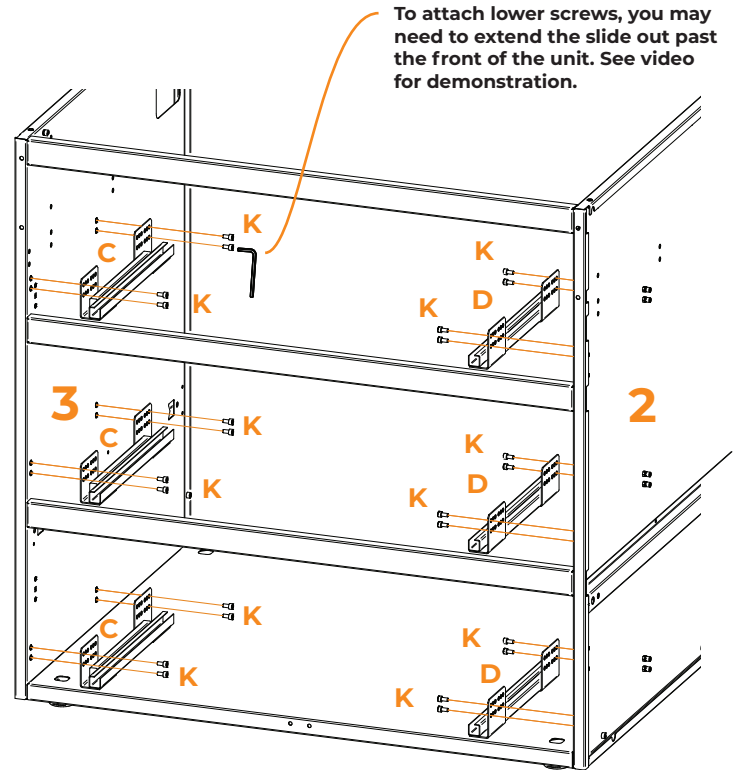

## Step 6 | FOR STORAGE 65 UNIT WITH TRASH DRAWER

Attach **L-Drawer Slide (C - 2X)** to **L-Side Panel (3)** and **R-Drawer Slide (D - 2X)** to **R-Side Panel (2)** with **Screw M5x12 (K - 16X)**, secure with an allen wrench (or hex head).

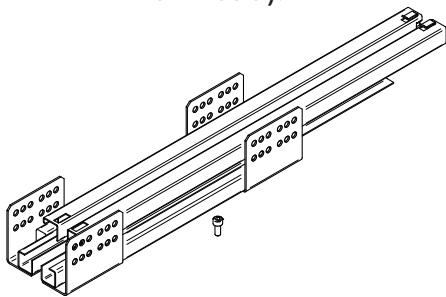

#	COMPONENT	QTY
K	SCREW M5X12	16
C	L-DRAWER SLIDE	2
D	R-DRAWER SLIDE	2

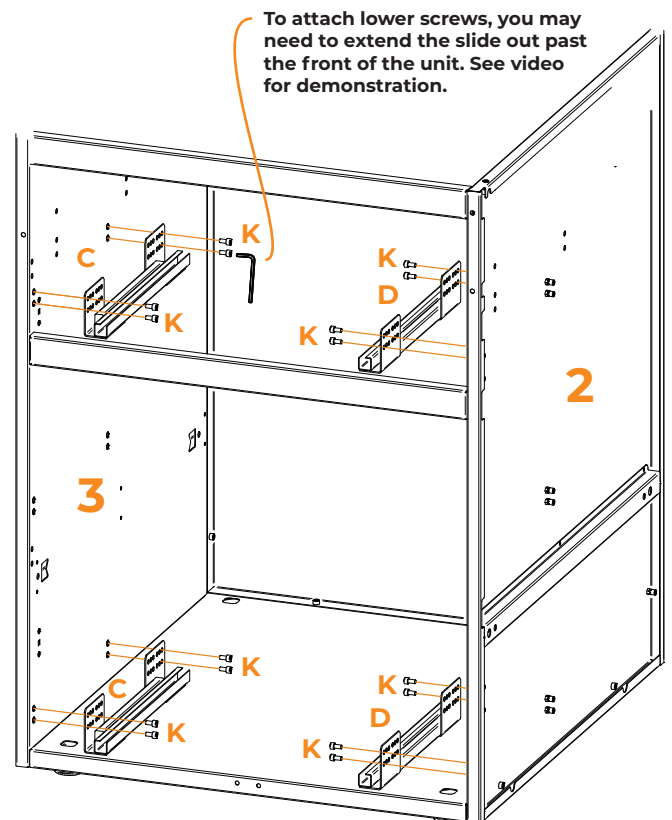

# INSTRUCTIONS

**Step 7** | Attach **Countertop (4)** to **L-Side Panel (3)** and **R-Side Panel (2)** with **Screw M5x12 (K - 4X)**, secure with an allen wrench (or hex head).

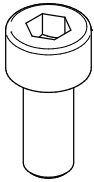

#	COMPONENT	QTY
K	SCREW M5X12	4

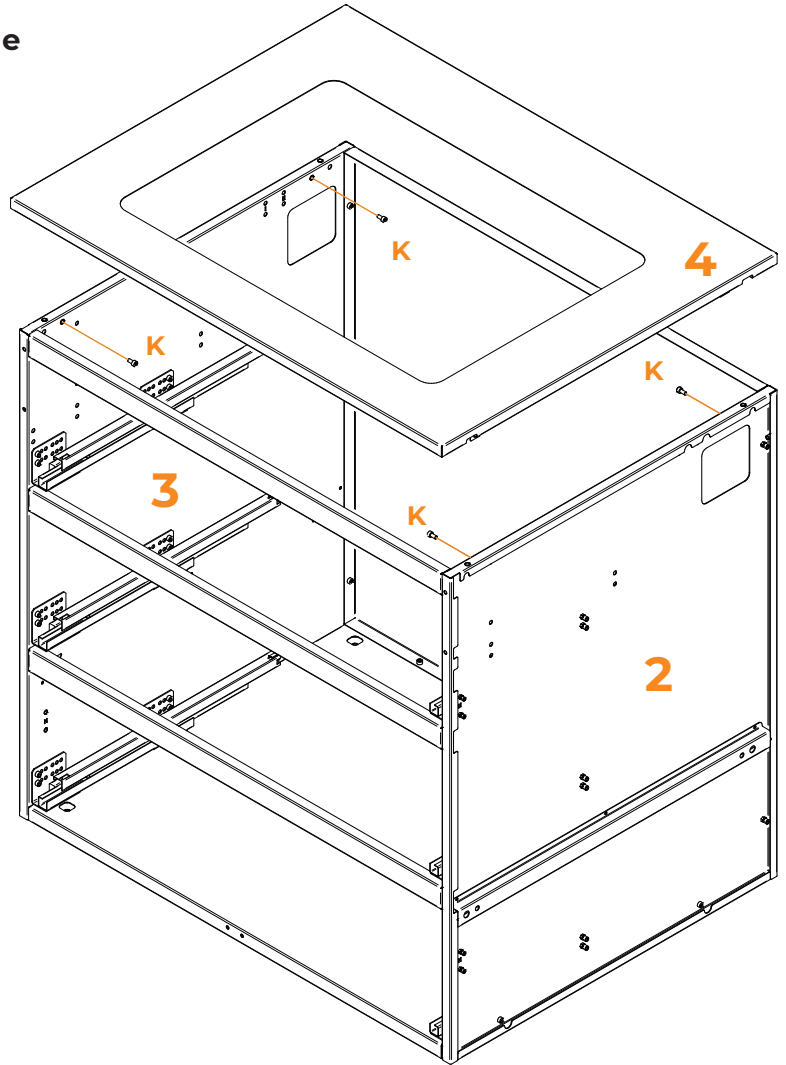

\* Example image: STORAGE 90

**Step 8** | FOR STORAGE 90 UNIT

Attach **Side-Front Fix (G - 2X)** to **Drawer Front (8)** with **Screw M4x16 Countersunk (O - 6X)**, secure with phillipshead screwdriver. Repeat for all **Drawer Fronts**.

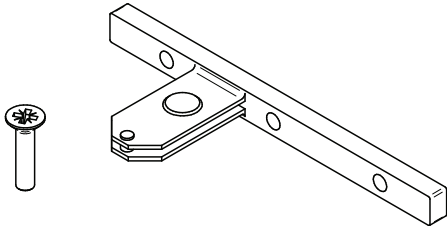

#	COMPONENT	QTY
O	SCREW M4X16 COUNTERSUNK	6 (per drawer)
G	SIDE-FRONT FIX	2 (per drawer)

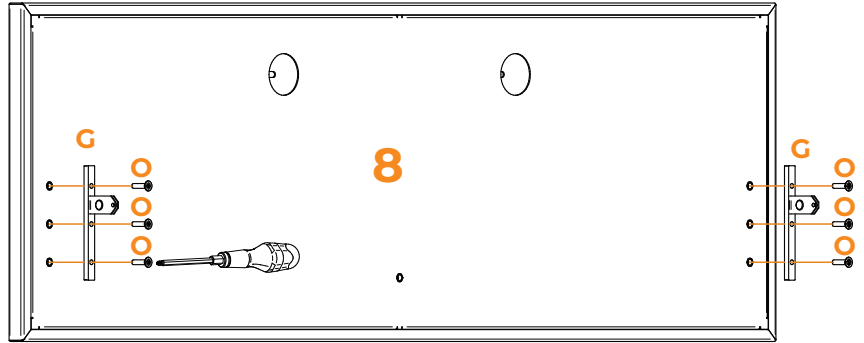

\* Example image: STORAGE 90

**Step 8** | FOR STORAGE 65 UNIT WITH TRASH DRAWER

Attach **Side-Front Fix (G - 2X)** to **Upper Drawer Front (8U)** with **Screw M4x16 Countersunk (O - 6X)**, secure with phillips head screwdriver. Repeat for **Lower Drawer Front (8L)**.

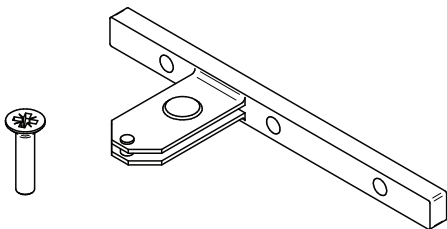

#	COMPONENT	QTY
O	SCREW M4X16 COUNTERSUNK	6 (per drawer)
G	SIDE-FRONT FIX	2 (per drawer)

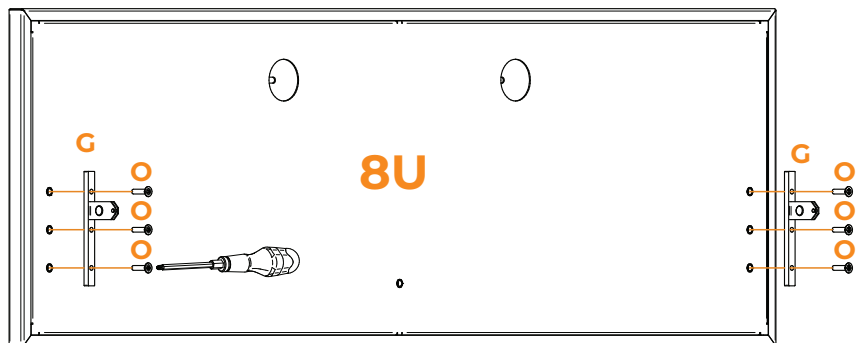

\* Example image: STORAGE 65

**Step 9** | Slide **L-Drawer Corner (E)** into the end of **L-Drawer Side (A)**. Slide **R-Drawer Corner (F)** into the end of **R-Drawer Side (B)**. Repeat for all **Drawer Fronts**.

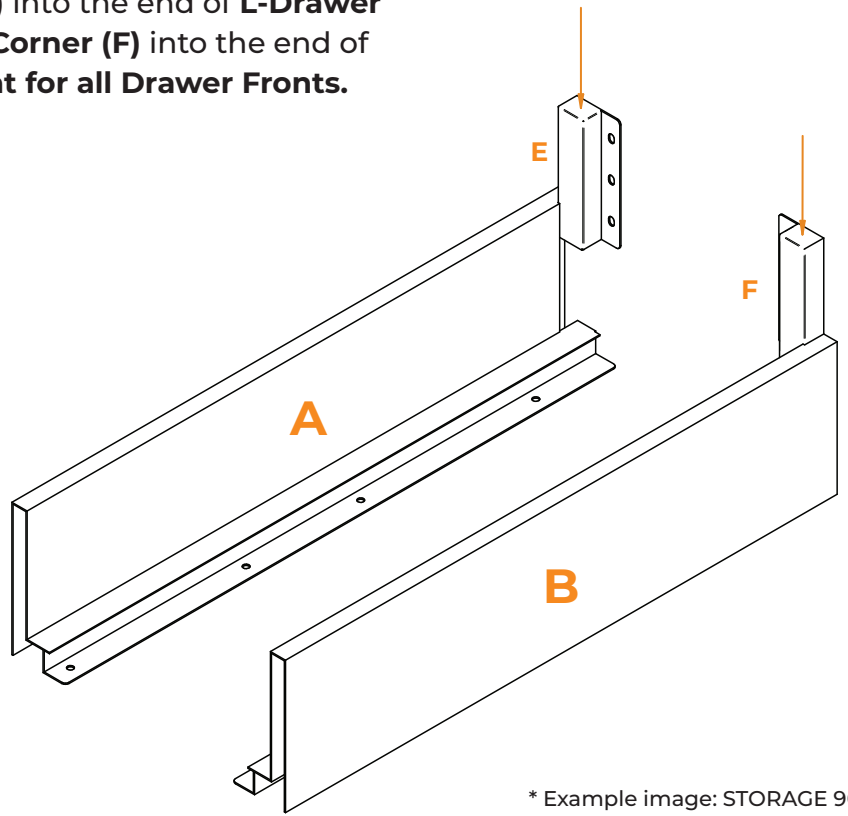
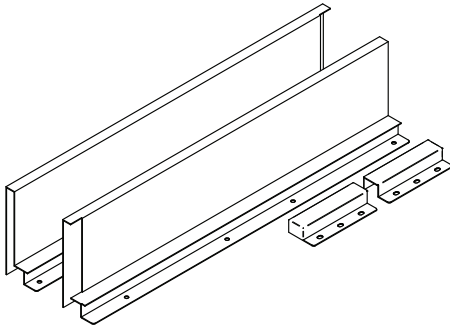

#	COMPONENT	QTY
A	L-DRAWER SIDE	1
B	R-DRAWER SIDE	1
E	L-DRAWER CORNER	1
F	R-DRAWER CORNER	1

\* Example image: STORAGE 90

**Step 10** | Using **Screw M4x10 (M)** and a phillips head screwdriver, attach **Drawer Bottom (9)** to **L-Drawer Side (A)** and **R-Drawer Side (B)**. Then attach **Drawer Back (10)** to **L-Drawer Corner (E)** and **R-Drawer Corner (F)**. Then attach **Drawer Bottom (9)** to **Drawer Back (10)**. Repeat for all **Drawers**.

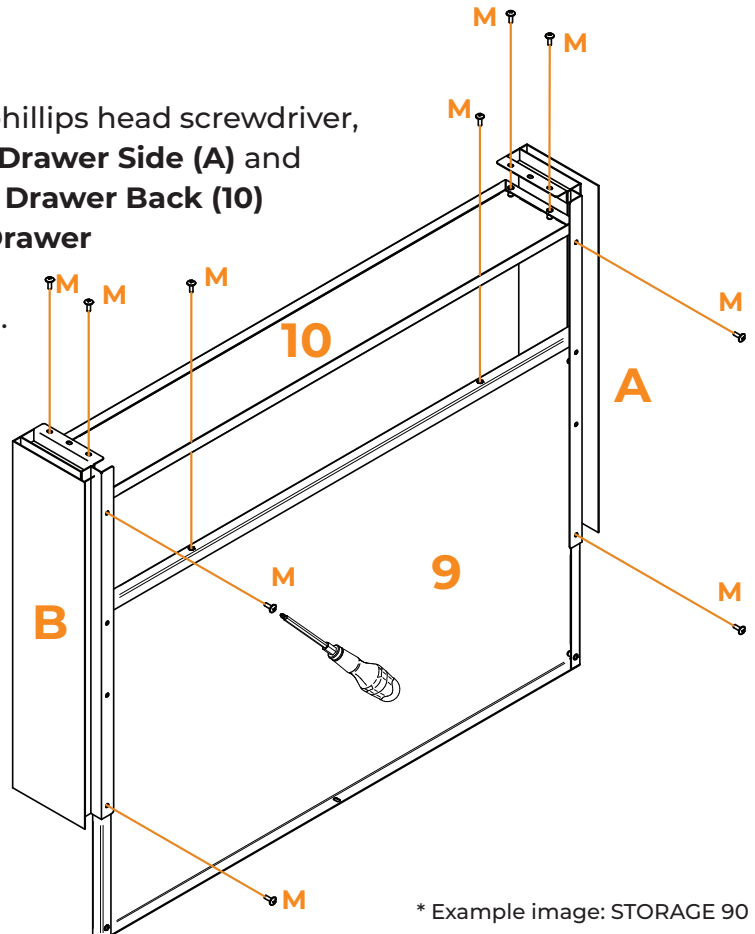
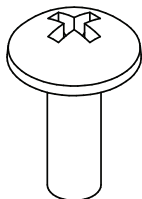

#	COMPONENT	QTY
M	SCREW M4X10 ROUNDHEAD	10

\* Example image: STORAGE 90

**Step 11** | Using **Screw M4x10 (M)** and a phillips head screwdriver, attach **L-Drawer Side (A)** and **R-Drawer Side (B)** to the **Side-Front Fix (G - 2X)**. Then attach the **Drawer Bottom (9)** to the **Drawer Front (8)**. Repeat for all Drawers.

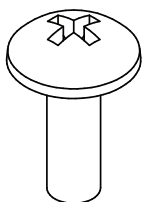

#	COMPONENT	QTY
M	SCREW M4X10 ROUNDHEAD	1

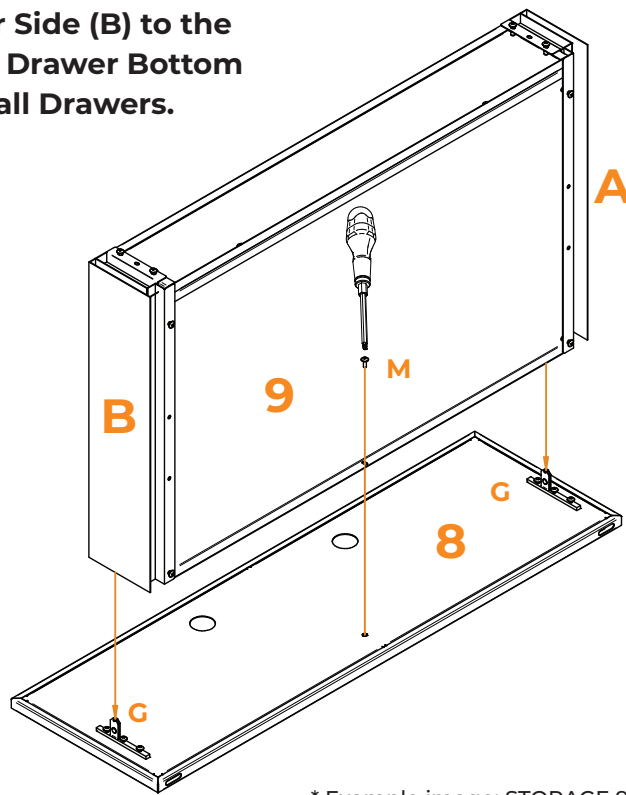

\* Example image: STORAGE 90

**Step 11** | FOR STORAGE 65 UNIT WITH TRASH DRAWER

Attach **Bin Box Top (11)** to **Bin Box L-Side (12)** and **Bin Box R-Side (13)** using **Screw M4X10 (M - 6X)** and **M4 Nut (P - 6X)**, secure with phillips head screwdriver and adjustable wrench.

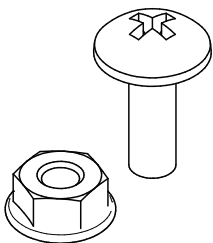

#	COMPONENT	QTY
M	SCREW M4X10 ROUNDHEAD	6
P	M4 NUT	6

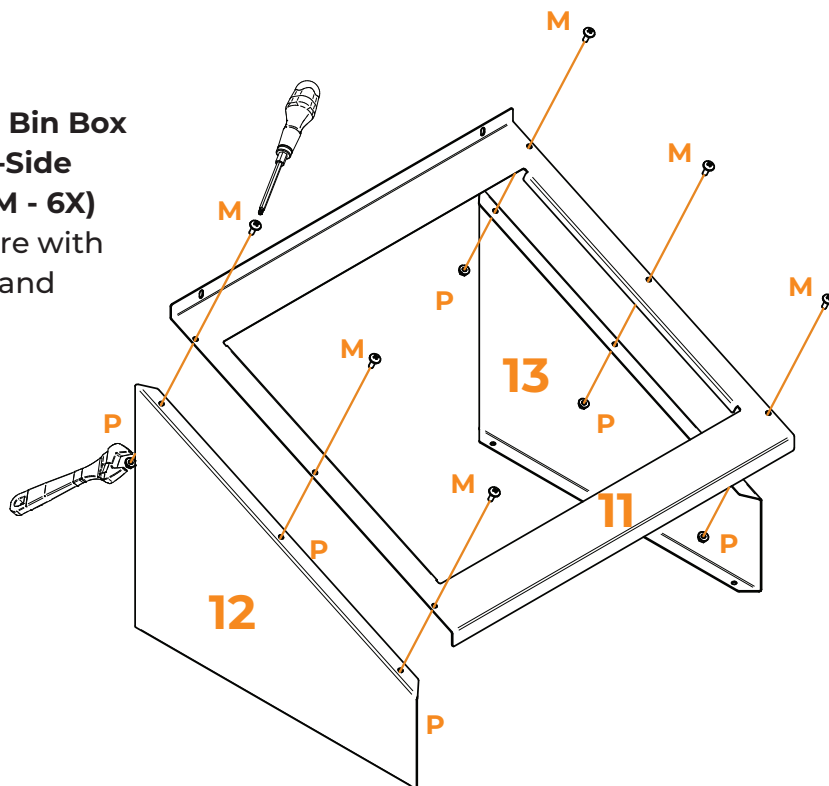

\* Example image: STORAGE 65

# INSTRUCTIONS

## Step 12 | FOR STORAGE 65 UNIT WITH TRASH DRAWER

Attach **Bin Box L-Side (12)** and **Bin Box R-Side (13)** to **Drawer Bottom (9)** using **Screw M4X10 (M - 4X)** and **M4 Nut (P - 4X)**, secure with phillips head screwdriver and adjustable wrench.

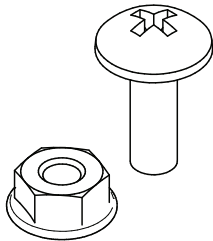

#	COMPONENT	QTY
M	SCREW M4X10 ROUNDHEAD	4
P	M4 NUT	6

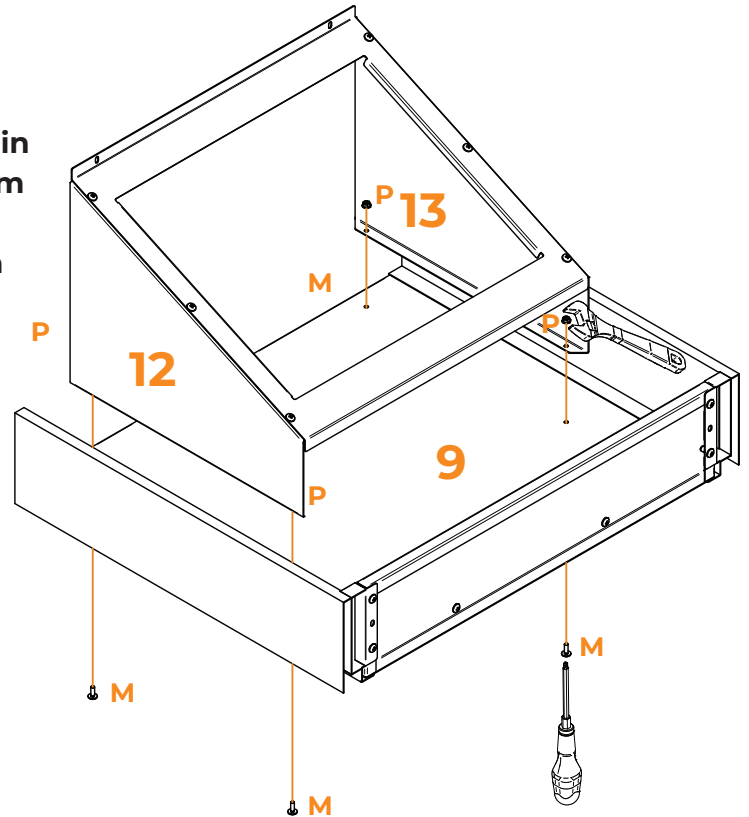

## Step 13 | Using Screw M4x10 (M) and a phillips head screwdriver, attach L-Drawer Side (A) and R-Drawer Side (B) to the Side-Front Fix (C - 2X). Then attach the Drawer Bottom (9) to the Lower Drawer Front (8L).

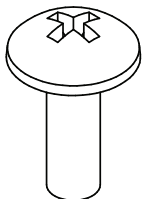

#	COMPONENT	QTY
M	SCREW M4X10 ROUNDHEAD	5

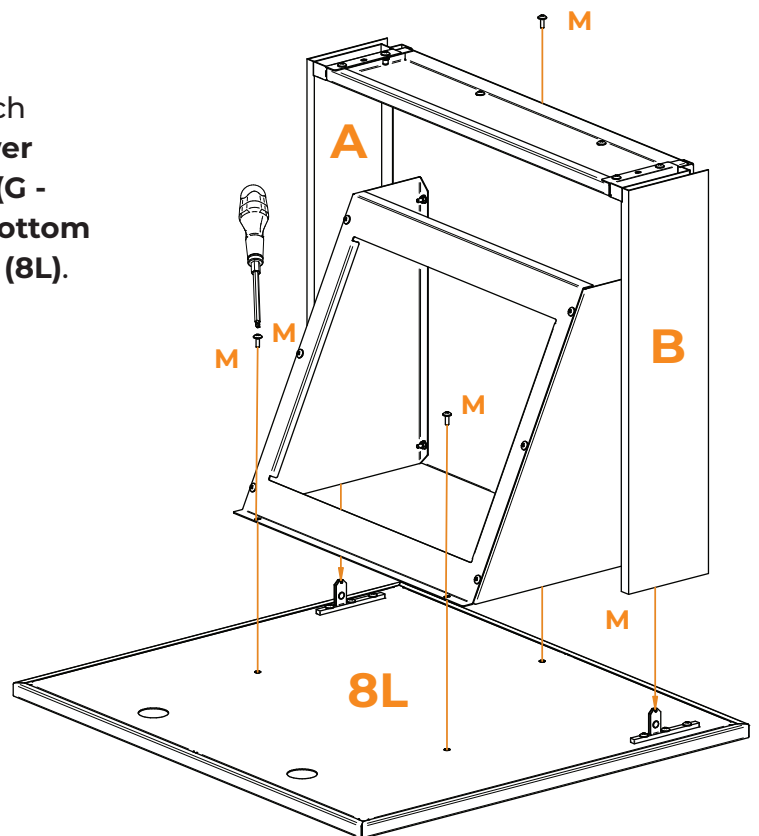

\* Example image: STORAGE 65

## Neolith Stone Installation

1. Stick the stone to the countertop plate using adequate adhesive to fix the stone in its place.
2. Remove any excess of adhesive using a damp cloth.

**RECOMENDATION:** When the outdoor kitchen is already mounted and positioned, FONTANA recommends to seal the seams between stones with outdoor suitable adhesive for best performance and results.

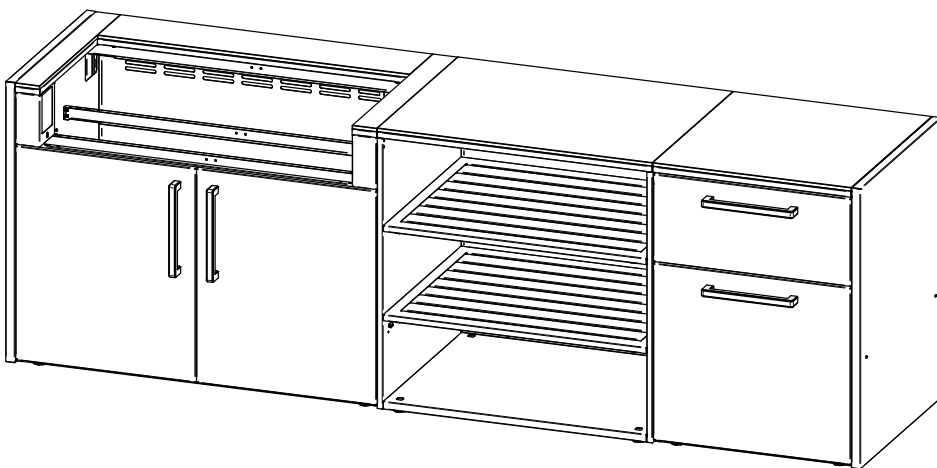
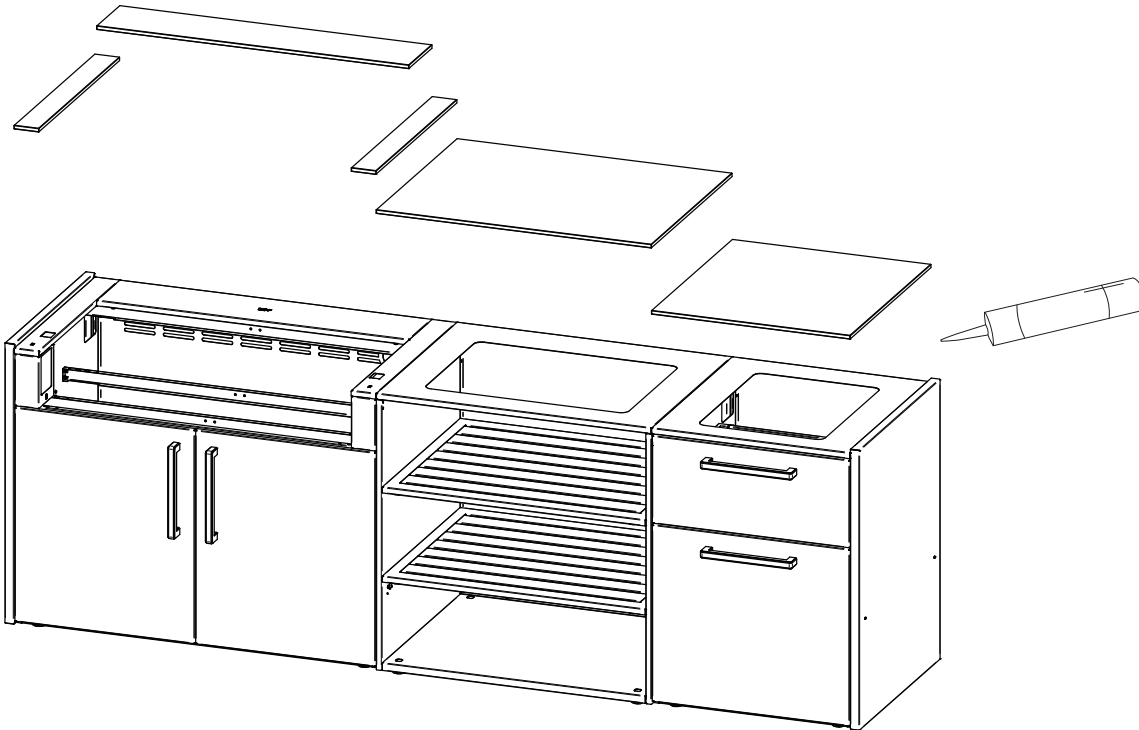

\* Example image: MODULE LUMEN 6 / OPEN SHELF / STORAGE 65

## Wall Assembly:

Use **M5X12 Screws (K - 4X)** to mount the corresponding Wall to the back of the ELYSIA module with an allen wrench (or hex head). Ensure the extra is positioned correctly.

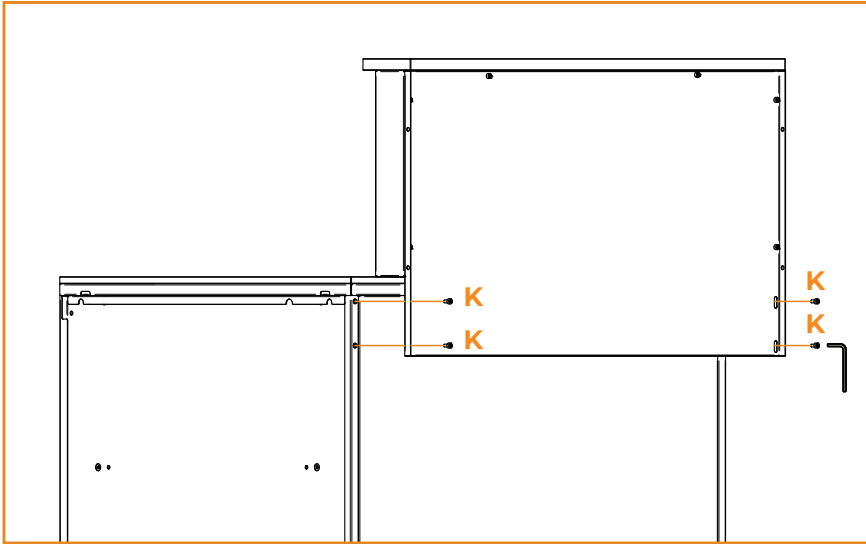

\* Example image: WALL 90

## Leg Adjustment Screw

There are four visible orifices on top of the bottom plate of every module. Inside you can see the leg regulation screw. Use an Allen wrench to set all the legs until the module is settled and has proper leveling. Must be done with the module positioned in its definitive location.

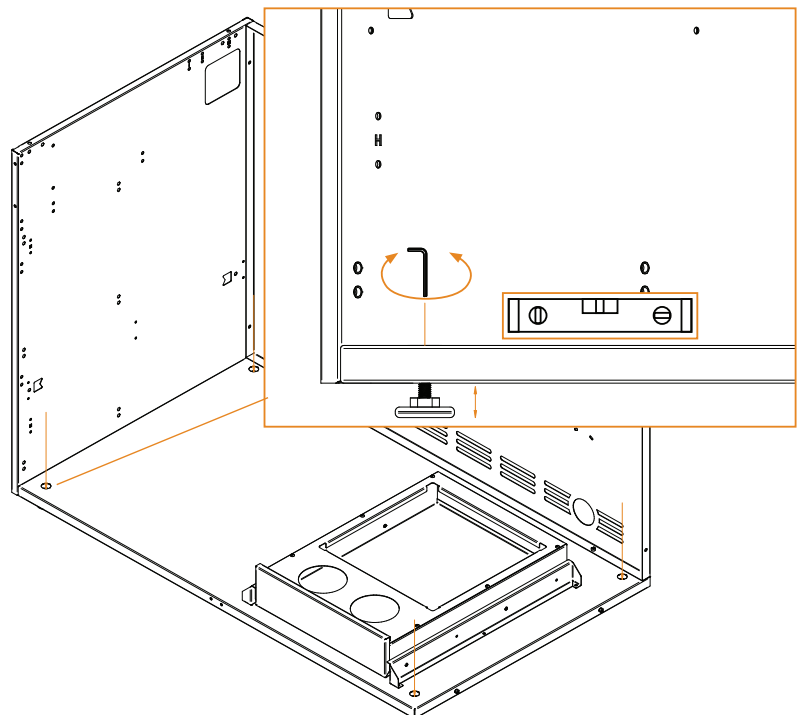

\* Example image: MODULE LUMEN 6

## Module to Module Assembly Step 01:

Use **M6X16 Button Head Screw (I - 4X)** to install spacer cylinders **M6x35 (M - 4X)** in the places shown with an allen wrench (or hex head). It is necessary to remove the drawers. ELYSIA Outdoor Modular Kitchen supplies extra M6X16 screws to ensure the user always have enough screws to assembly ELYSIA Outdoor Modular Kitchen.

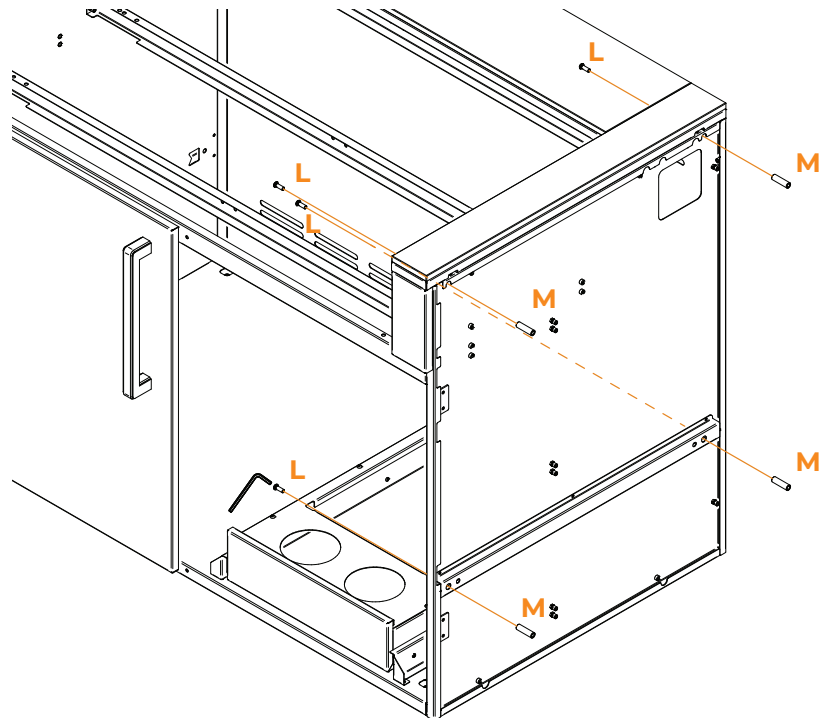

\* Example image: MODULE LUMEN 6

## Module to Module Assembly Step 02:

Use **M6X16 Button Head Screw (I - 4X)** to assembly one module to another, screwing the bolts to previous installed spacer cylinders (M) in the first module (shown left in the image) from the inside of the second module (shown right in the image).

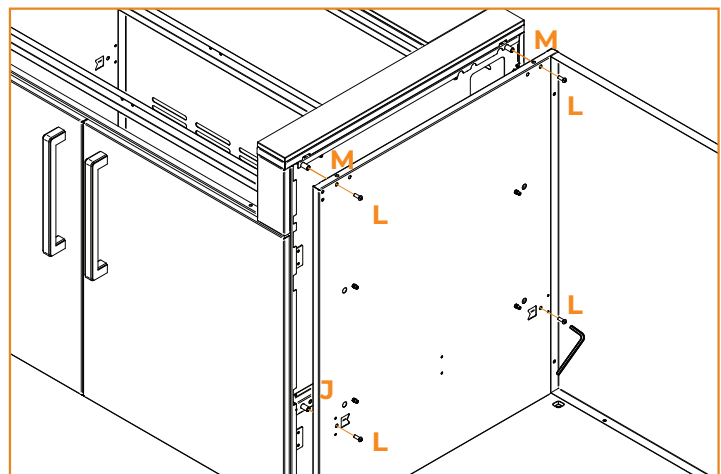
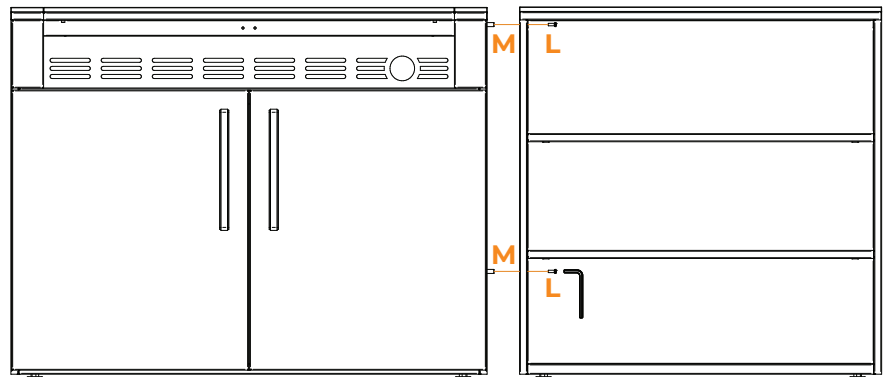

\* Example image: MODULE LUMEN 6 / STORAGE 90

## Module Countertop Adjustment

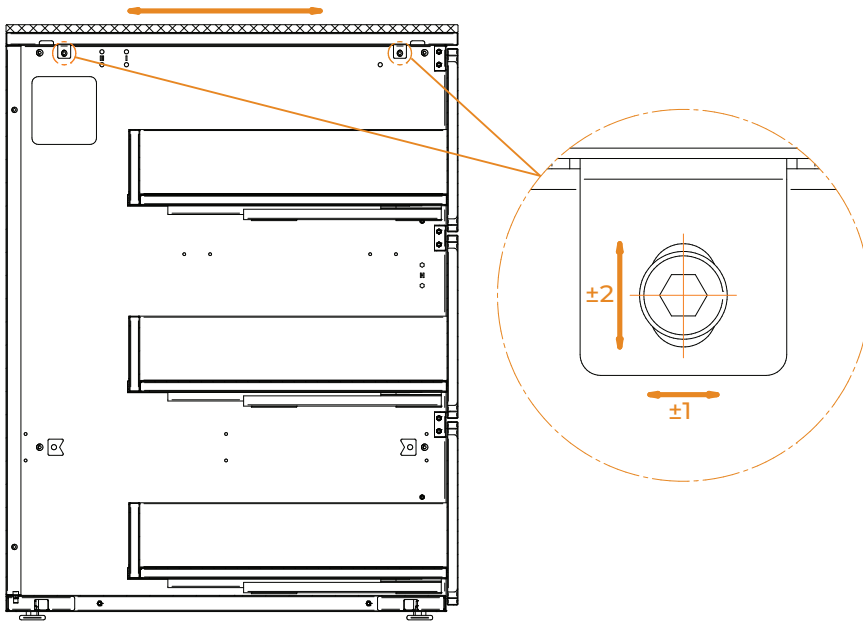

Adjust the countertops until they are level.

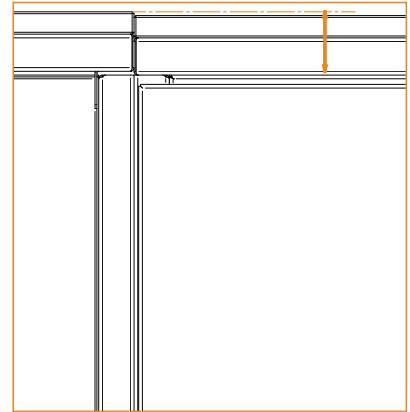

## Tolerance Range for Wall Adjustment

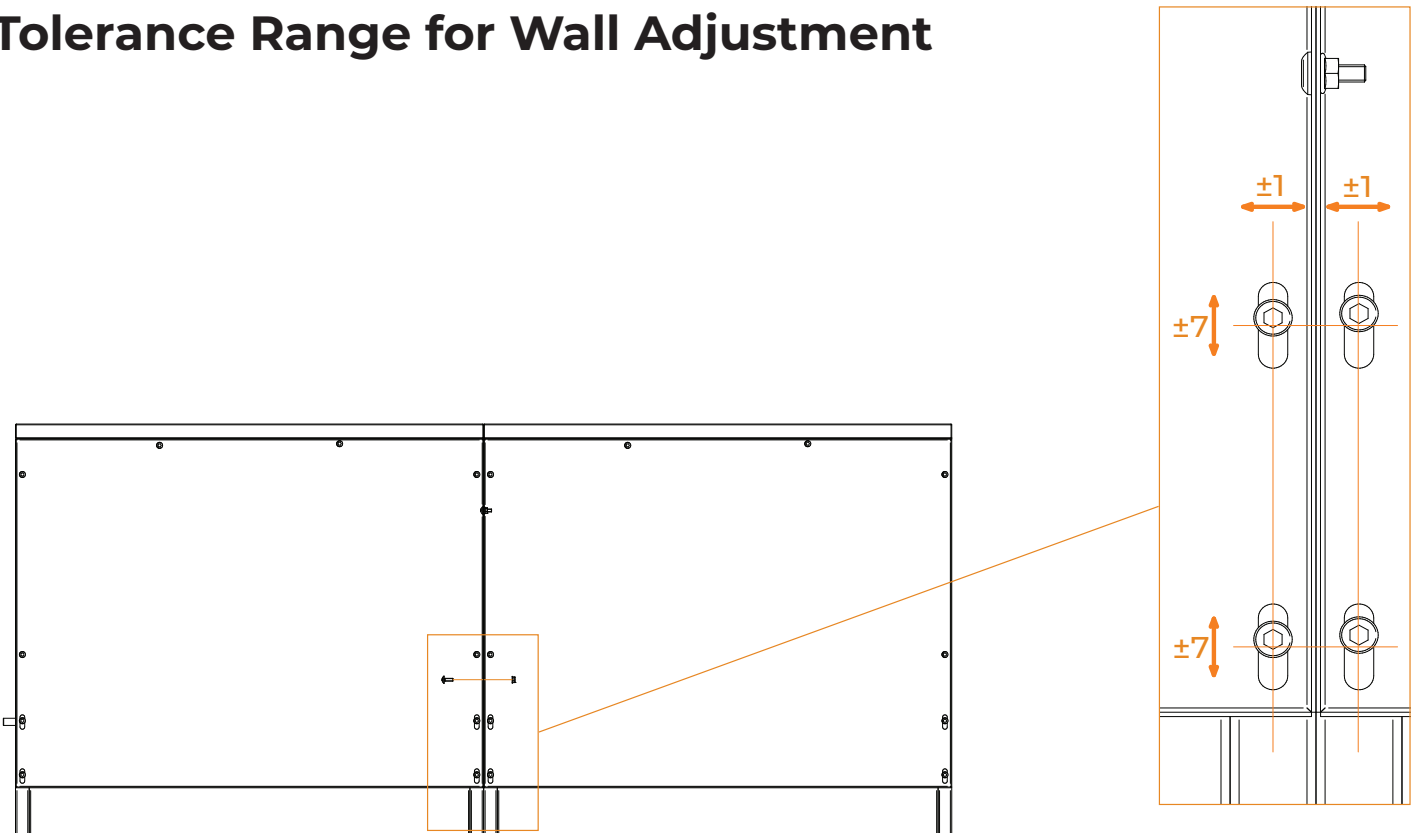

\* Example image: WALL 65

## End Panels / Kamado End Panels:

Place the **M6X15 hexagonal spacers (i)** along with their **washers** in the indicated locations, and secure them with the **M6 nuts (ii - 4 pcs on End Panels 1, 2 pcs on Kamado End Panels 2)**.

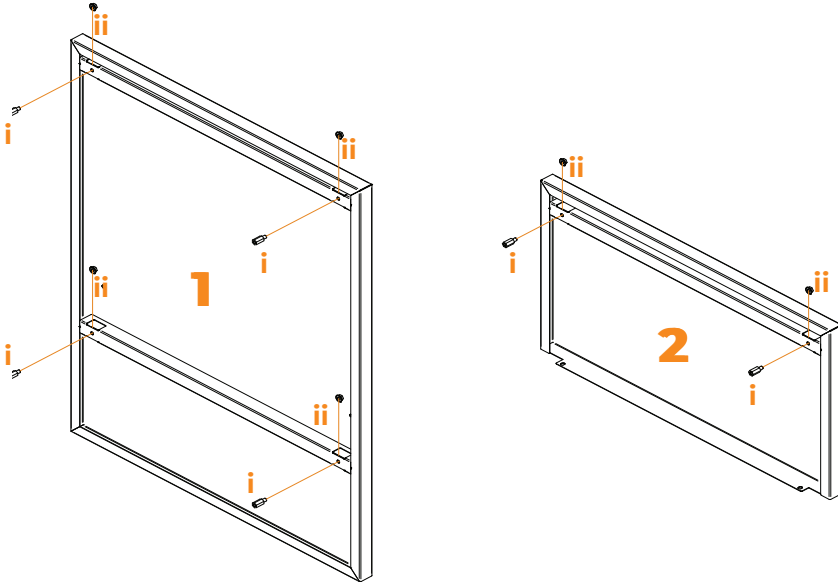

\* Example image: END PANEL / KAMADO END PANEL

## End Panel Mountage:

Use **M6X10 screws (iii - 4pcs)** to install the **End Panel** to the side of the module with an allen wrench (or hex head). It is necessary to remove drawers to screw inside screws if module has any.

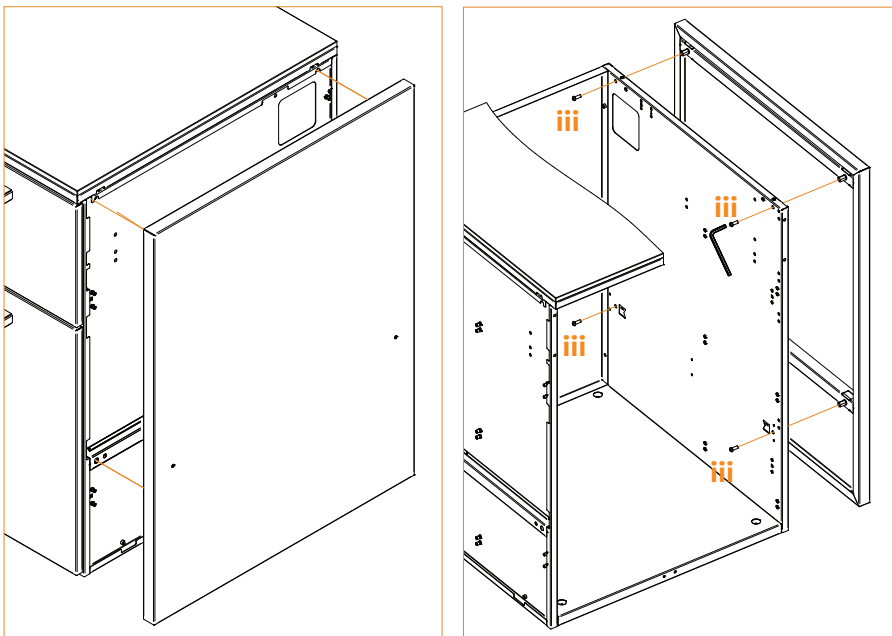

\* Example image: STORAGE 65

## Handles Assembly:

Use **M4x12 bolt (1 - 2X per handle supplied)** to assemble the handles to module doors or drawers front plate.

### Handles Available



**Black Handle**



**Stainless Steel Handle**

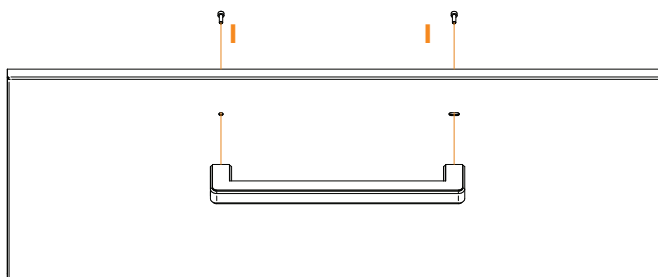
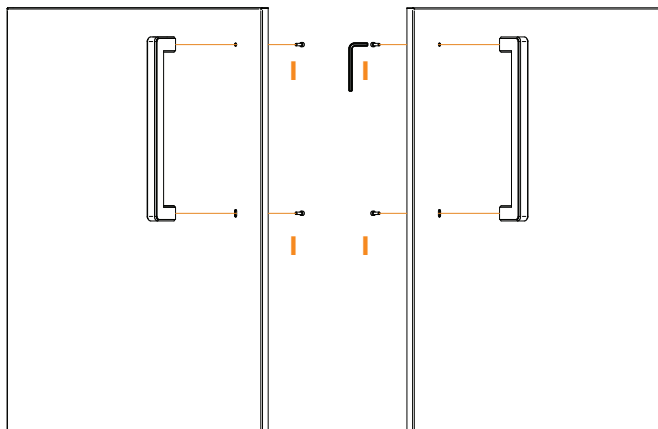

\* Example image: MODULE LUME 6 / MODULE KAMADO

## Installing Drawer:

To install the drawer of a ELYSIA Outdoor Modular Kitchen module, simply align the channel at the bottom of the drawer with the slides and push the drawer inward.

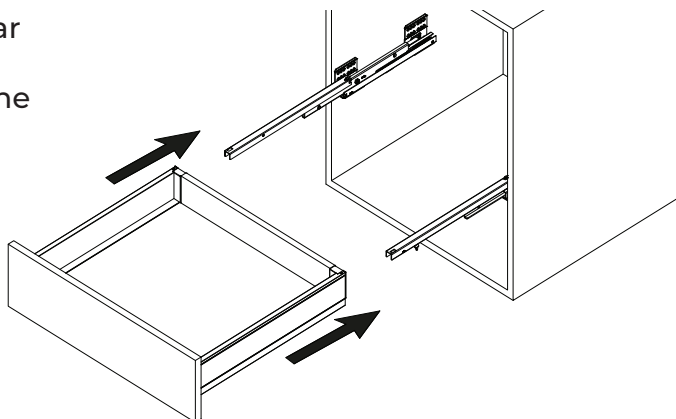

## Remove Drawer:

To remove the drawer from a ELYSIA Outdoor Modular Kitchen module, simply engage the tab located at the bottom of the guide and pull the drawer outward.

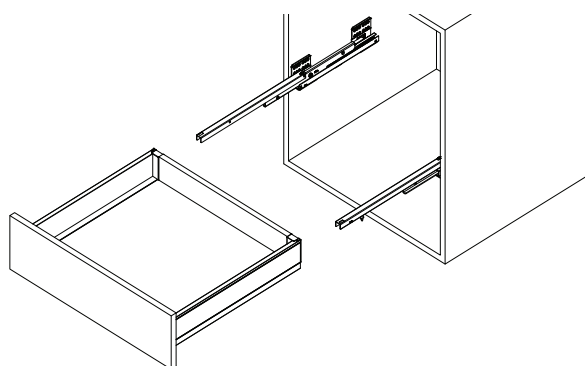
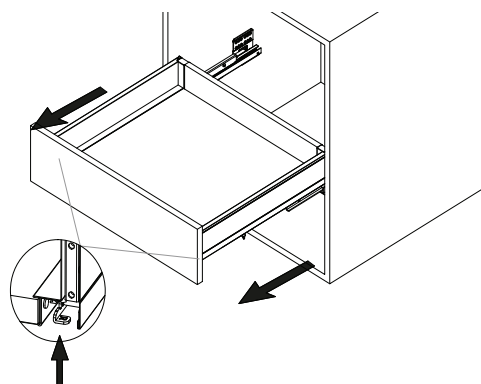

# ADJUSTMENT

## Guides Adjustment:

Guides can be adjusted using both screw visible at inside lateral of the guide. As it is shown below, lower screw is used for left-right adjust while upper screw is used for up-down adjust.

Left-Right Adjustment

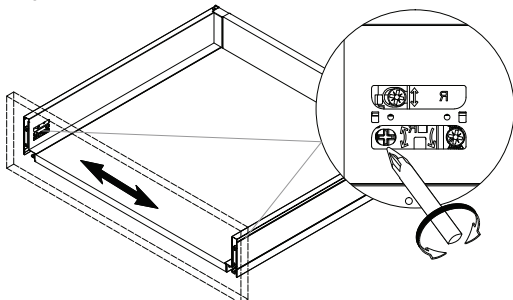

± 1.5 mm

Up-Down Adjustment

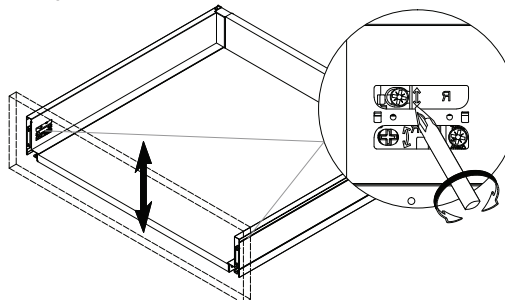

± 1.5 mm

To prolong the life of your ELYSIA Outdoor Modular Kitchen please follow the recommended maintenance instructions:

## Powder Coated Surfaces

Scheduled cleaning will benefit and extend the long lasting aesthetics of the finish. This procedure is an integral part of the warranty given for surface finish and color retention and it will minimize the weathering effect of dirt and other airborne pollutants which tend to accumulate on the surface of the coating, dulling its appearance. We suggest the following guidelines:

- Cleaning of the coated surfaces with warm water and mild detergent or non abrasive pH-banaced cleaner solution, and the use of non abrasive brush or sponge.
- The cleaning solution should not be allowed to be in contact with the powder coated surface for more than 30 minutes.
- DO NOT use any chlorides or quaternary salts on the module. DO NOT use any hydrochloric acid (muriatic acid) on modules. Refrain from using harsh chemicals, solvents, or abrasive cleaners, as they can damage the powder coating. Opt for cleaners specifically designed for powder-coated surfaces.
- After cleaning, the surface shall be completely rinsed-off with clean fresh water to remove any cleaning residue. This helps prevent the accumulation of cleaning agents that might affect the powder coating over time.
- A record of all cleaning schedules, frequencies and products should be kept and documented.
- While cleaning is crucial, avoid using high-pressure washers, as the force can damage the powder coating. Stick to gentle cleaning methods to ensure the longevity of the finish.

Hard water deposits can affect the appearance of the powder coating over time. When the outdoor kitchen is not in use, consider using protective covers to shield it from the elements. This helps prevent exposure to harsh sunlight, rain, and other environmental factors that could impact the powder coating. If your area has hard water, consider wiping down the surfaces after rain or watering to prevent water spots.

## Neolith Stone Maintenance

Please take extra care when cleaning your top Neolith stone. Although solvents, such as acetone, are often recommended by counter manufacturers and fabricators, these substances your ELYSIA Outdoor Modular Kitchen powder coated finish.

To clean your countertop stone, use soapy water and a damp cloth. If there are stains encrusted/dry, you have to soak the stain with a standard detergent and wait to rub with a damp cloth.

Special consideration with ceramic knives which may scratch Neolith's surface in every finish.

# ELYSIA

OUTDOOR MODULAR KITCHEN BY **FONTANA**  
F O R N I

---

877.842.9822 | [support@fontanaovens.com](mailto:support@fontanaovens.com) | [FontanaOvens.com](https://FontanaOvens.com)