

ELYSIA

OUTDOOR MODULAR KITCHEN BY **FONTANA**
FORNI



OVEN MODULE

Instruction Manual

Oven 90

Oven 100



PAGE INTENTIONALLY LEFT BLANK

Introduction.....	2
Suggested Tools for Assembly.....	2
Product Dimensions.....	3
Parts List.....	4
Components List.....	5
Instructions.....	6
Adjustment.....	19
Cleaning and Maintenance.....	20

BEFORE YOU START

Welcome to your Elysia Outdoor Modular Kitchen

Save these instructions.

- Read these instructions completely and carefully. Do not skip any step. Put all bolts used in a step before tightening them.
- Some parts have sharp edges, care must be taken to avoid injury. Please wear gloves when handling.
- Two or more people should work together to assemble the kitchen modules and FONTANA Appliances.
- During assembly, work on a protected surface to avoid damaging the pieces.



Instruction Video

Tap & Hold (mobile)
or Scan to Watch
the Video

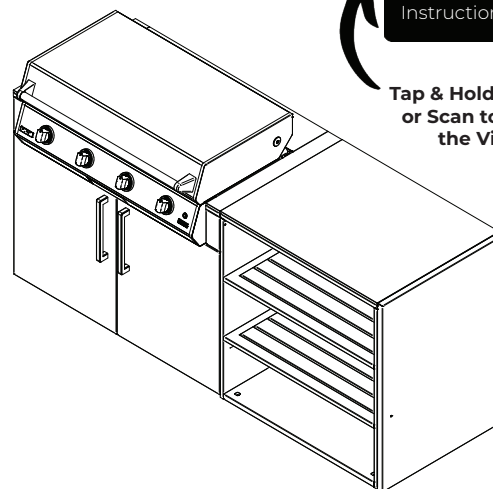

SUGGESTED TOOLS FOR ASSEMBLY

1 - Phillips Head

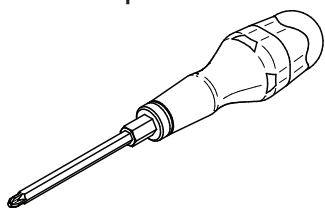

1 - Adjustable wrench
(or 7mm nut driver bit)

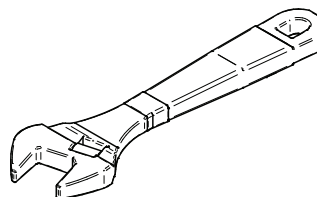

1 - Allen Wrench (CRV-4 Hex Head)

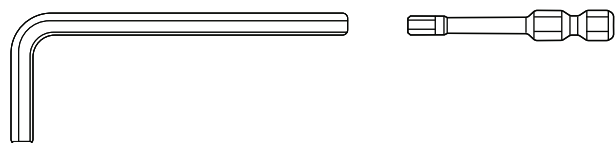

1 - Silicone Adhesive
Suitable for Ceramics

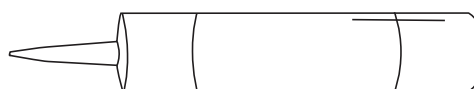

PRODUCT DIMENSIONS

Oven 90

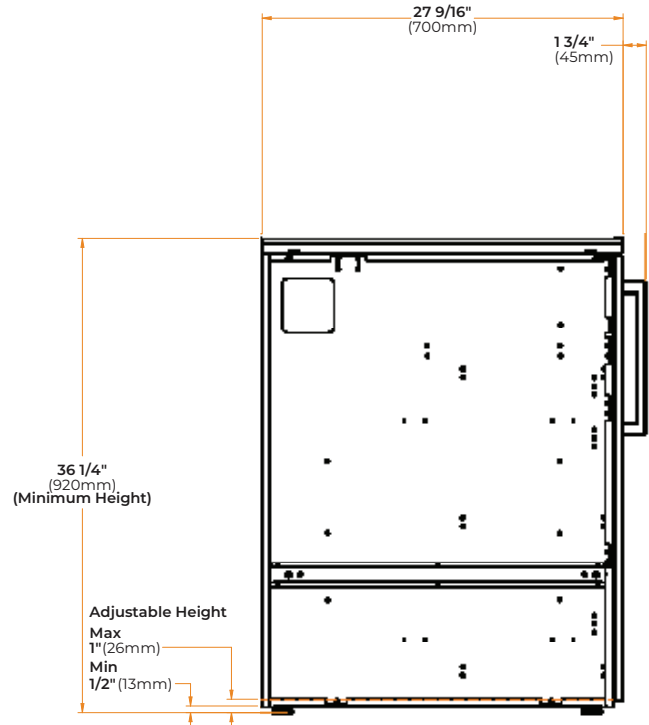
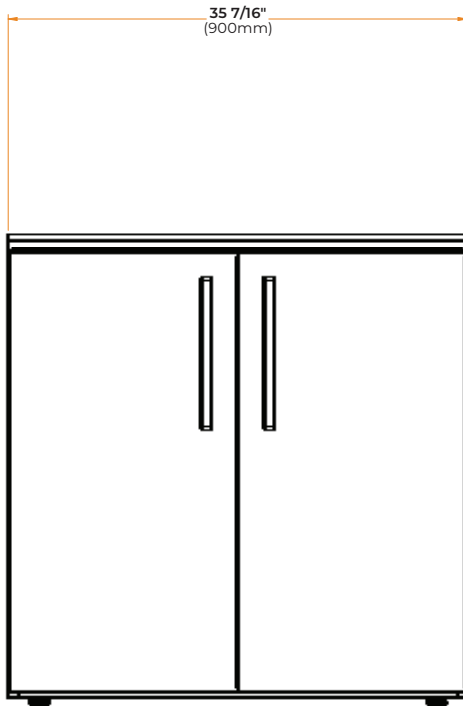

Oven 100

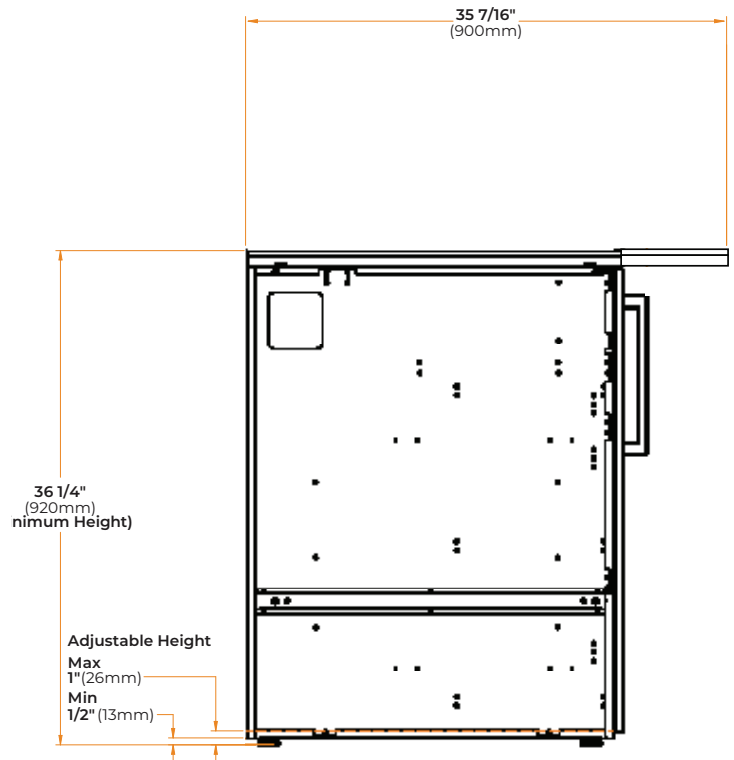
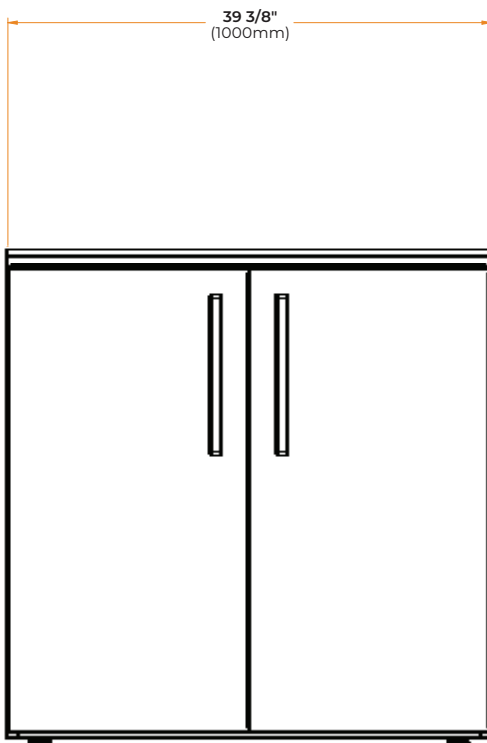

PARTS LIST

#	NAME	QTY
1	BASE	1
2	R-SIDE PANEL	1
3	L-SIDE PANEL	1
4	REAR	1
5	COUNTERTOP	1
6	RIB	1
7	STONE	1
8	R-DOOR	1
9	L-DOOR	1
10	GAS TANK TRAY	1
11	SLIDE SUPPORT	2

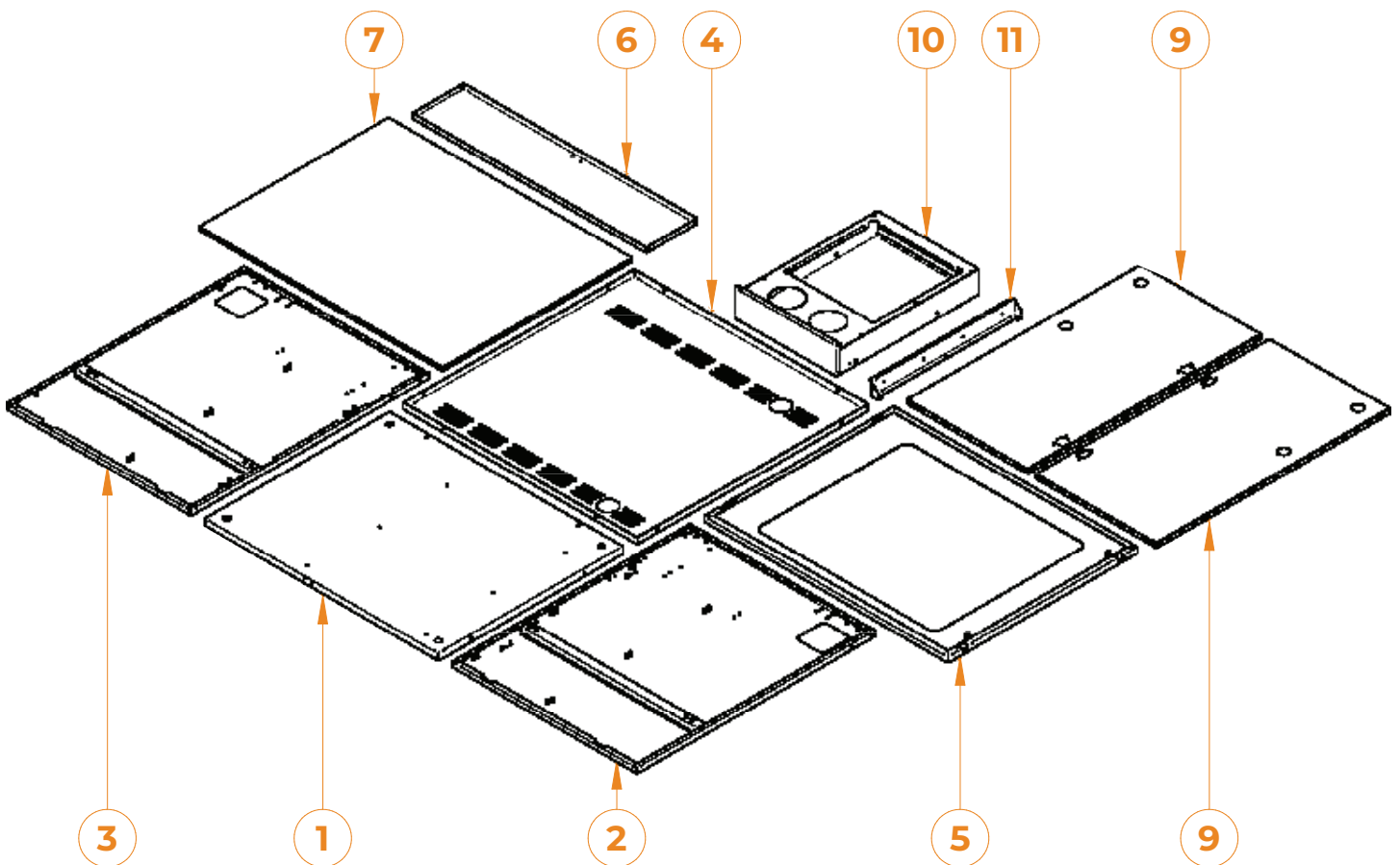

COMPONENTS LIST

#	NAME	QTY
A	TANK TRAY SLIDES	2
B	DOOR HANDLE	2
C	DOOR HINGE	4
D	NUT M4	14
E	SCREW M4X12	4
F	SCREW M4X10 ROUNDHEAD	14
G	SCREW M4X10 COUNTERSUNK	16
H	SCREW M5X12	18
I	SCREW 6X16 BUTTON HEAD	8
J	SPACER CYLINDER M6X35	4
K	ADJUSTABLE LEG	4
L	DOOR STOPPER	4
M	CABLE GROMMET	1

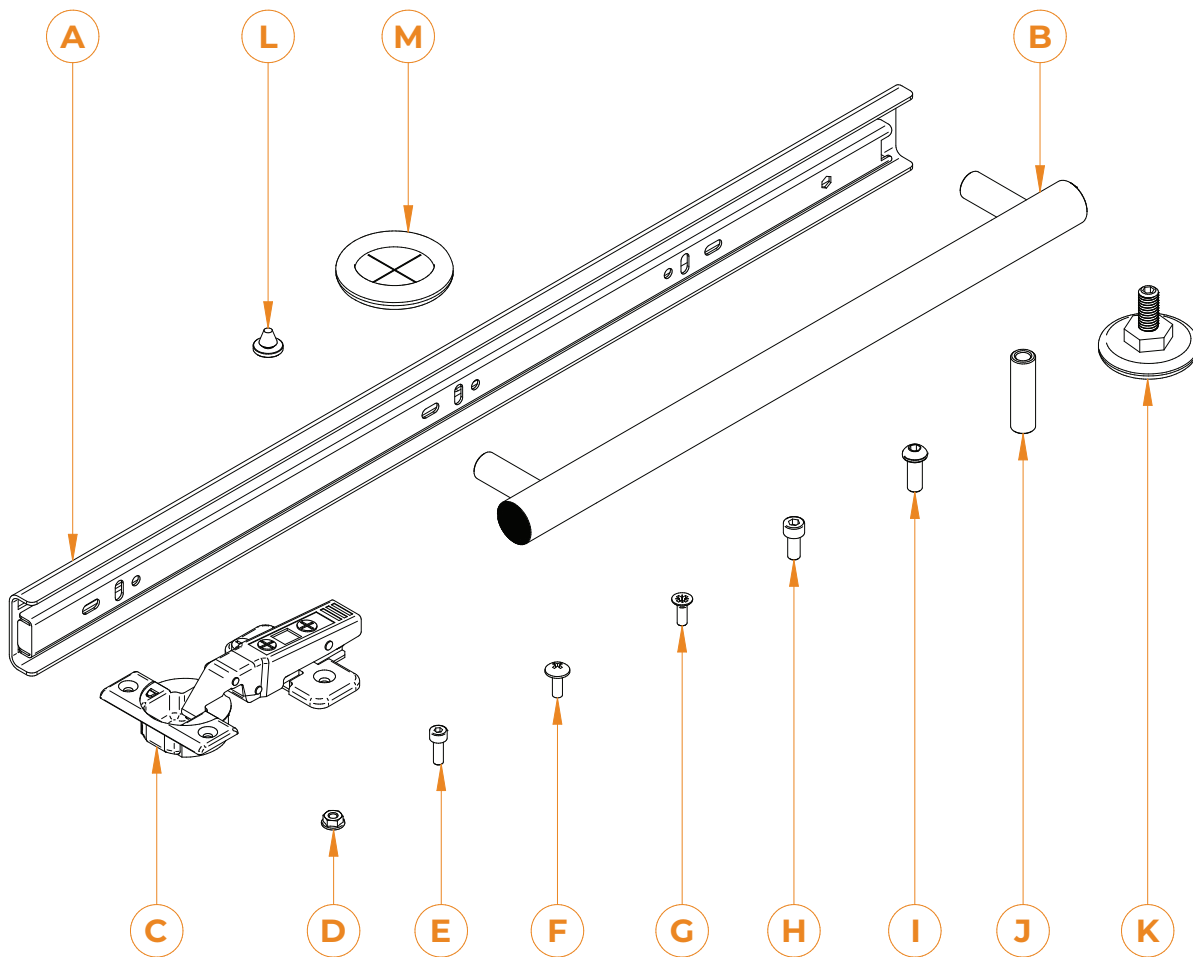

INSTRUCTIONS

Step 1 | Insert **Adjustable Legs (K - 4X)** in four corners of the **Base (1)**.

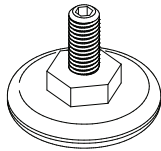

#	COMPONENT	QTY
R	ADJUSTABLE LEG	4
T	LEG CAP	4

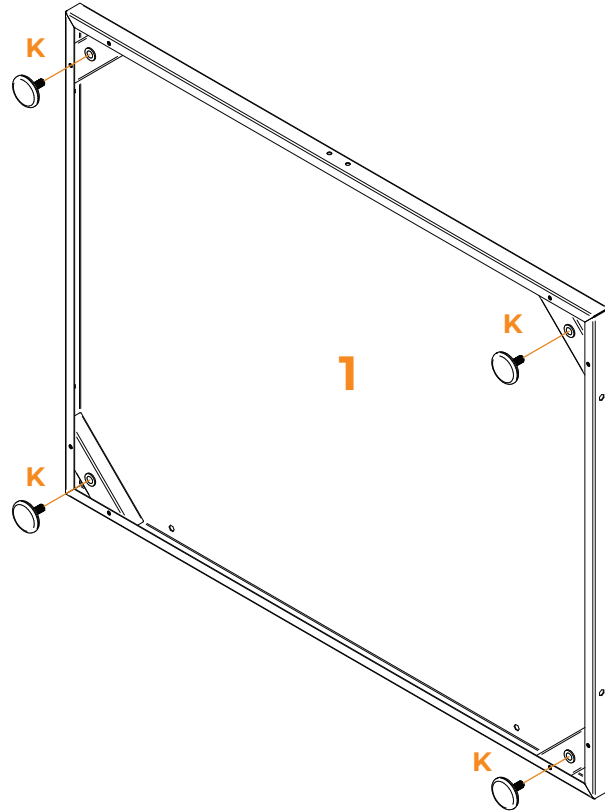

* Example image: OVEN 90

Step 2 | Attach the **Inner Tank Tray Slide (A - 2X)** to the **Gas Tank Tray (10)**, secure with phillips head screwdriver and adjustable wrench.

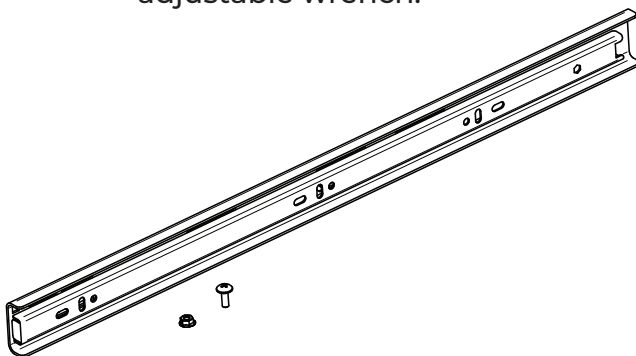

#	COMPONENT	QTY
A	TANK TRAY SLIDE	2
F	SCREW M4X10 ROUNDHEAD	4
D	M4 NUT	4

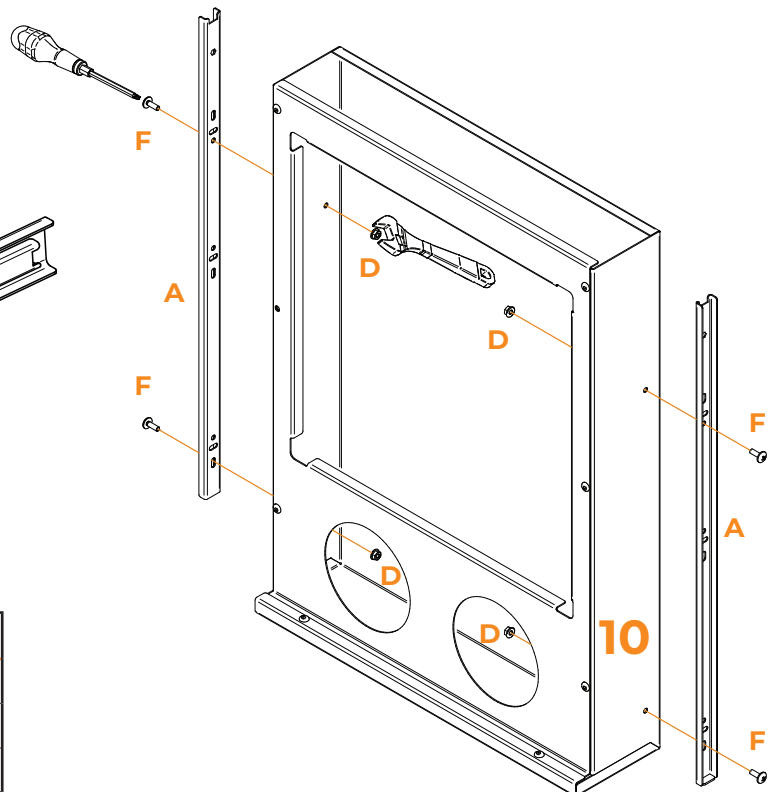

* Example image: OVEN 90

INSTRUCTIONS

Step 3 | Attach the **Outer Tank Tray Slide (A - 2X)** to the **Gas Tank Tray (10)**, secure with phillips head screwdriver and adjustable wrench.

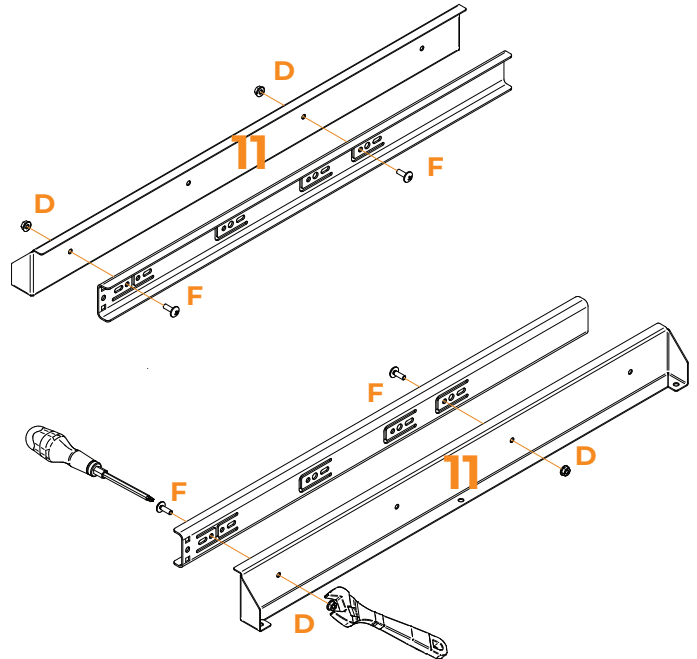
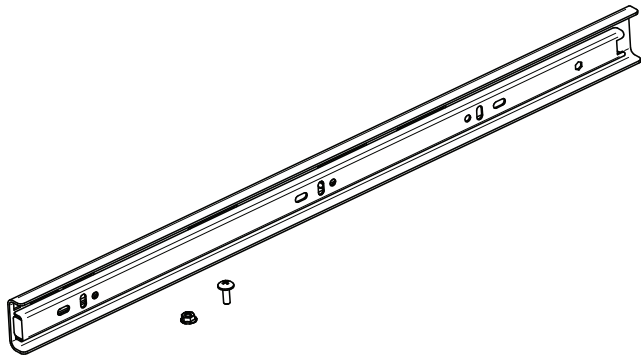

#	COMPONENT	QTY
A	TANK TRAY SLIDE	2
F	SCREW M4X10 ROUNDHEAD	4
D	M4 NUT	4

* Example image: OVEN 90

Step 4 | Attach **R-Side Panel (2)** to **Base (1)** and **Rear (5)** with **Screw M5x12 (K - 4X)**, secure with an allen wrench (or hex head).

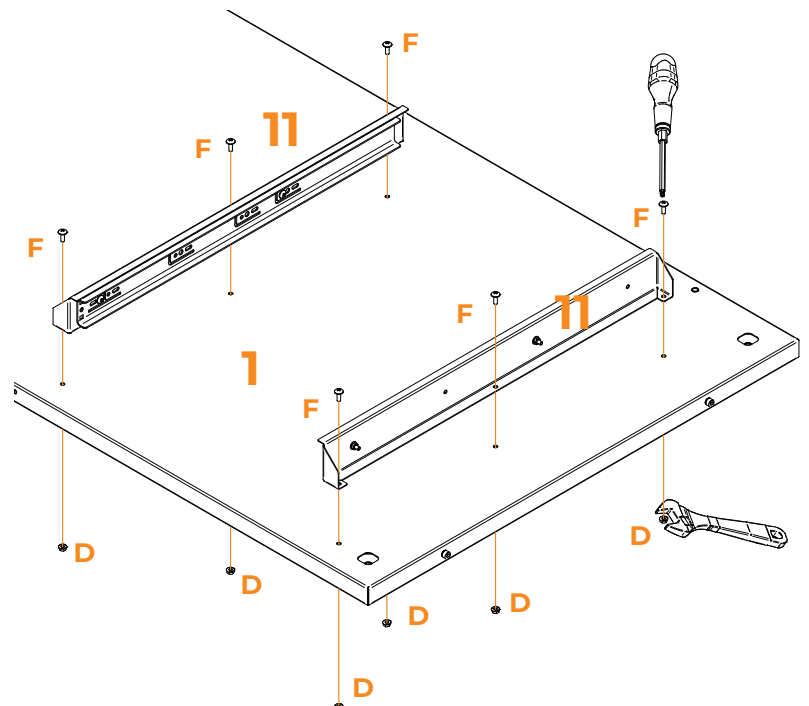
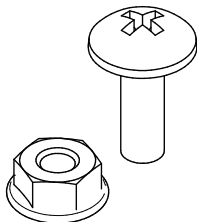

#	COMPONENT	QTY
F	SCREW M4X10 ROUNDHEAD	6
D	M4 NUT	6

* Example image: OVEN 90

INSTRUCTIONS

Step 5 | Align the **Inner Tank Tray Slide (A)** on the **Gas Take Tray (10)** with the **Outer Tank Tray Slide (A)** on the **Slide Supports (11 - 2X)**, and slide into place.

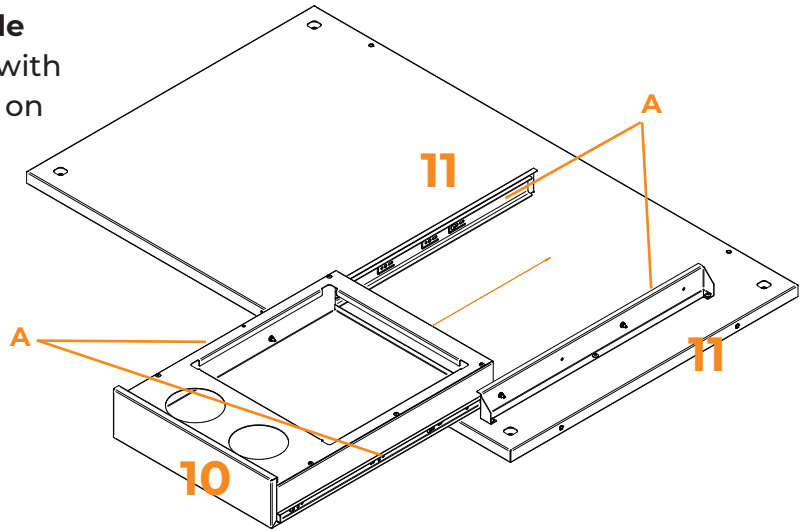

* Example image: OVEN 90

Step 6 | Attach the **Rear (4)** to the **Base (1)** with **Screw M5x12 (H - 2X)**, secure with an allen wrench (or hex head).

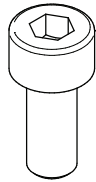

#	COMPONENT	QTY
H	SCREW M5X12	2

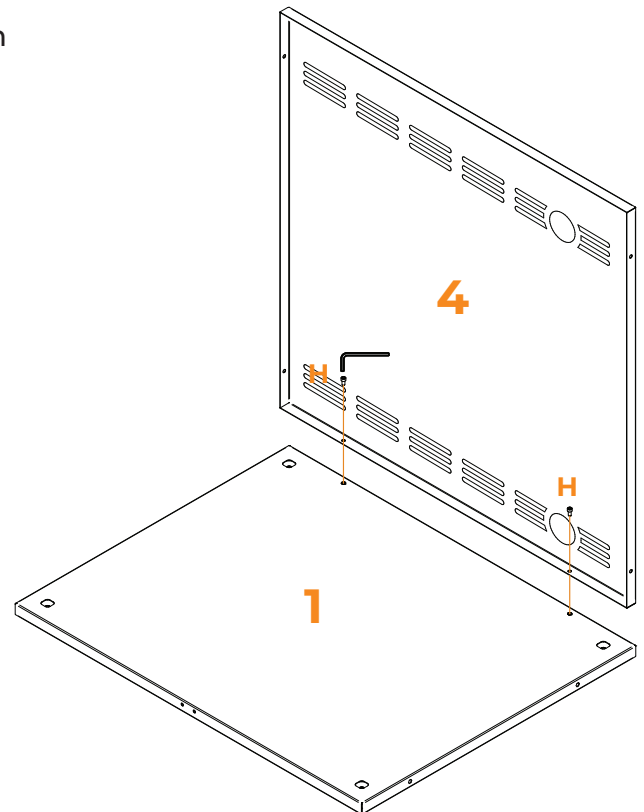

* Example image: OVEN 90

INSTRUCTIONS

Step 7 | Attach **L-Side Panel (3)** to **Base (1)** and **Rear (4)** with **Screw M5x12 (H - 4X)**, secure with an allen wrench (or hex head).

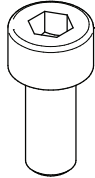

#	COMPONENT	QTY
H	SCREW M5X12	4

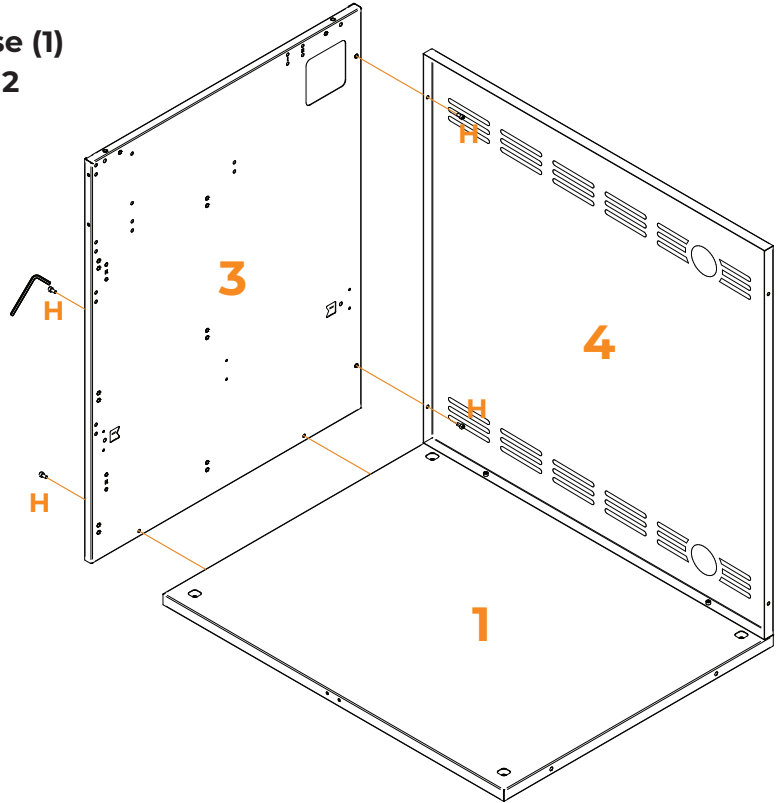

* Example image: OVEN 90

Step 8 | Attach **R-Side Panel (2)** to **Base (1)** and **Rear (4)** with **Screw M5x12 (H - 4X)**, secure with an allen wrench (or hex head).

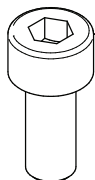

#	COMPONENT	QTY
K	SCREW M5X12	4

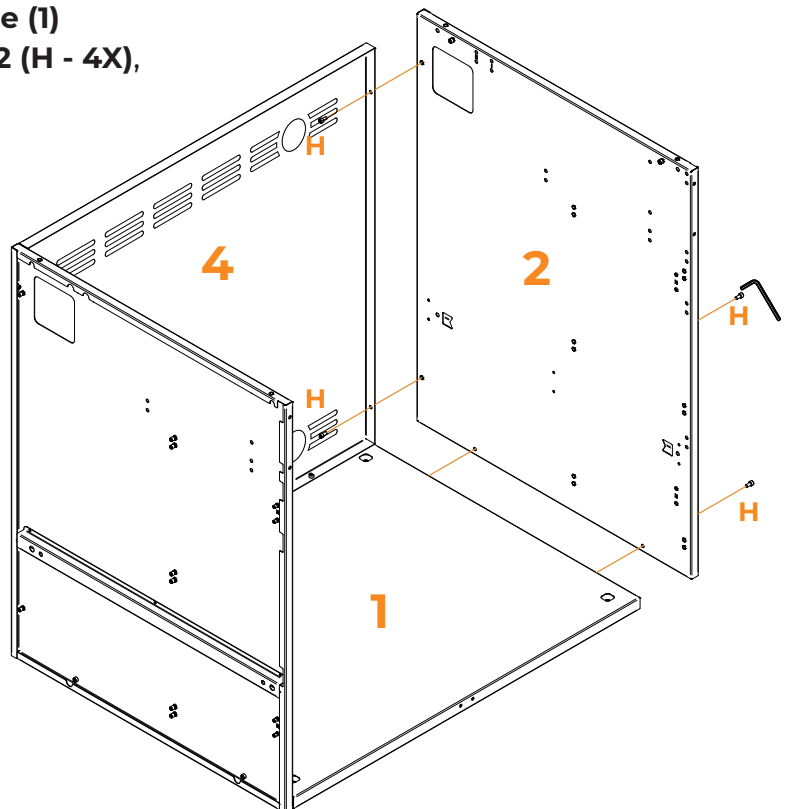

Step 9 | Attach **Rib (6)** to **R-Side Panel (2)** and **L-Side Panel (3)** with **Screw M5x12 (H - 4X)**, secure with an allen wrench (or hex head).

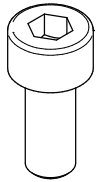

#	COMPONENT	QTY
H	SCREW M5X12	4

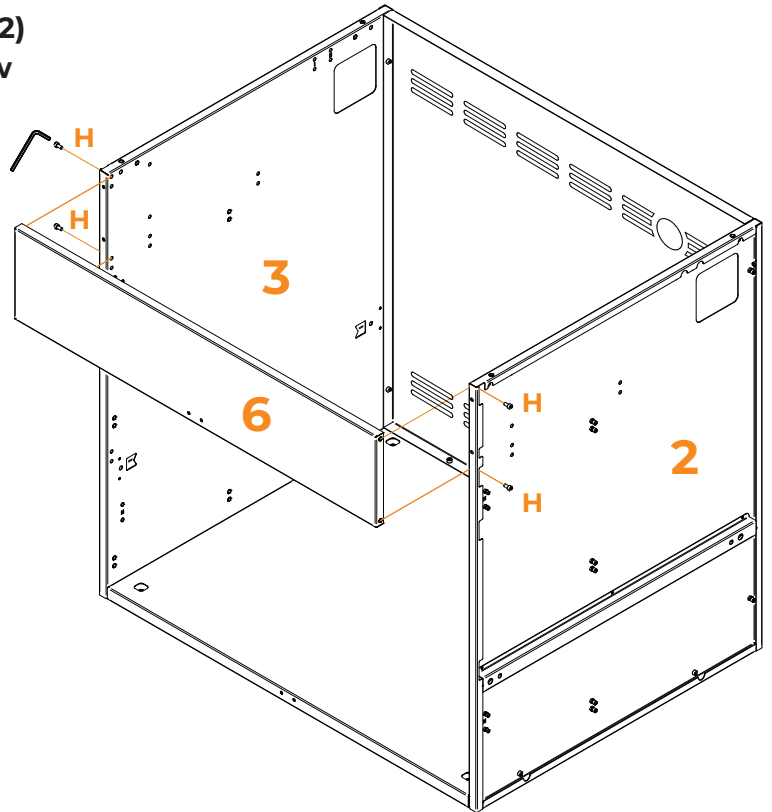

* Example image: OVEN 90

Step 10 | Attach **Countertop (5)** to **R-Side Panel (2)** and **L-Side Panel (3)** with **Screw M5x12 (H - 4X)**, secure with an allen wrench (or hex head).

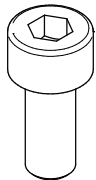

#	COMPONENT	QTY
H	SCREW M5X12	4

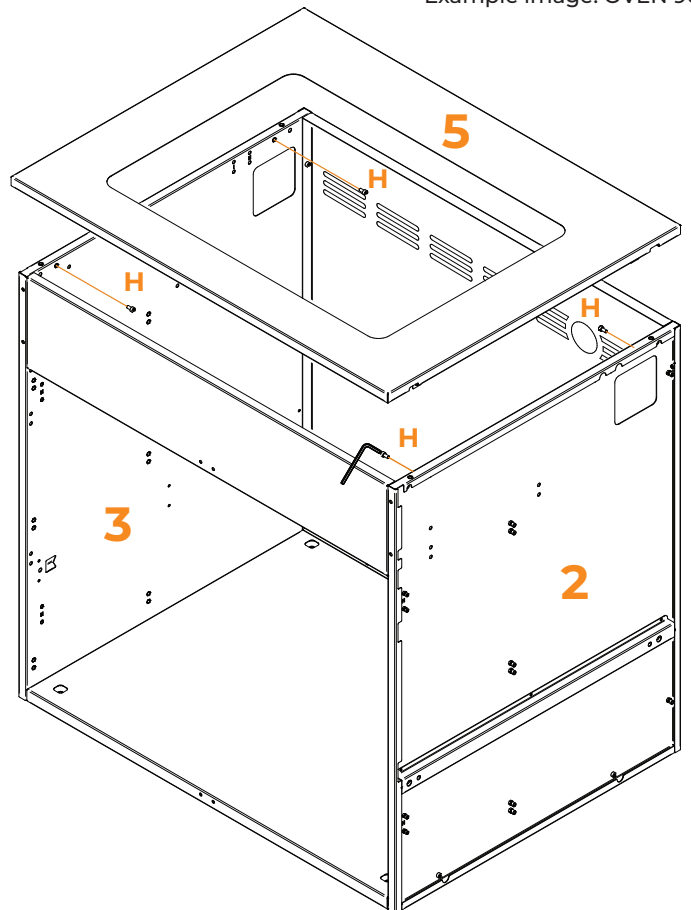

* Example image: OVEN 90

Step 11 | Attach **Door Hinges (C - 2X)** to desired **L-Side Panel (3)** and **L-Door (9)** with **Screw M4x16 (G - 6X)**, secure with a phillips head screwdriver. **Repeat for R-Side Panel.**

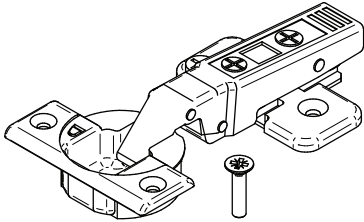

#	COMPONENT	QTY
C	HINGE	3
G	SCREW M4X16 COUNTERSUNK	8

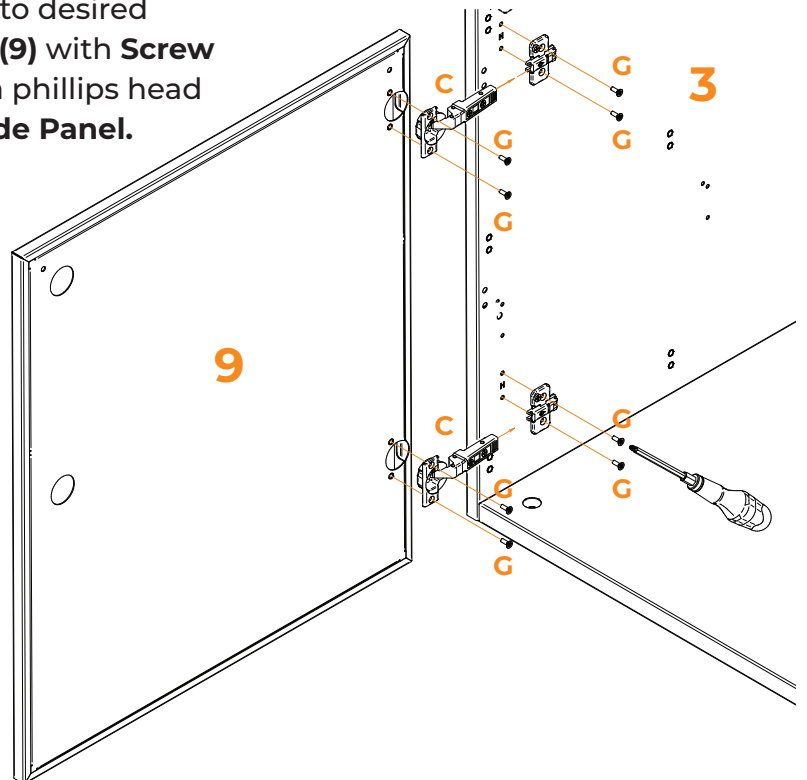

Neolith Stone Installation

1. Stick the stone to the countertop plate using adequate adhesive to fix the stone in its place.
2. Remove any excess of adhesive using a damp cloth.

RECOMENDATION: When the outdoor kitchen is already mounted and positioned, FONTANA recommends to seal the seams between stones with outdoor suitable adhesive for best performance and results.

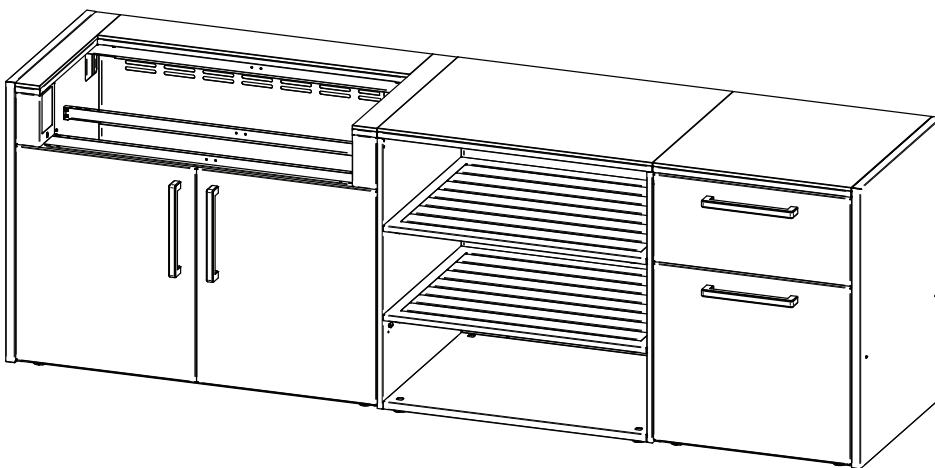
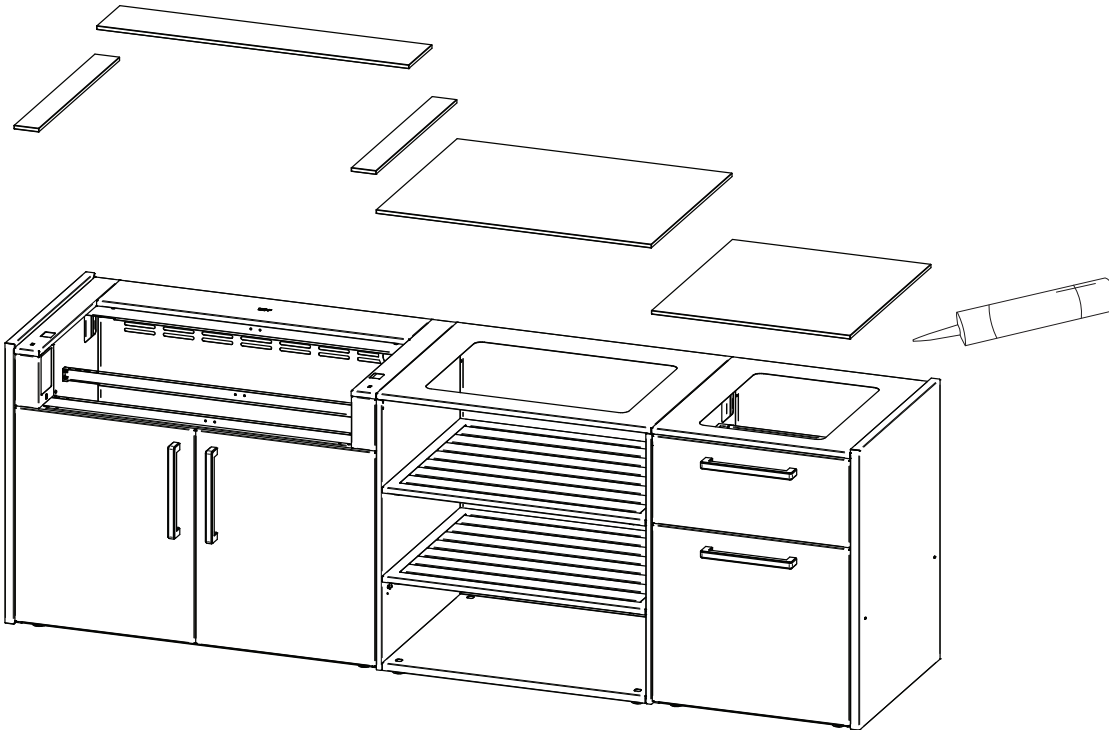

* Example image: MODULE LUMEN 6 / OPEN SHELF / STORAGE 65

Wall Assembly:

Use **M5X12 Screws (H - 4X)** to mount the corresponding Wall to the back of the ELYSIA module with an allen wrench (or hex head). Ensure the extra is positioned correctly.

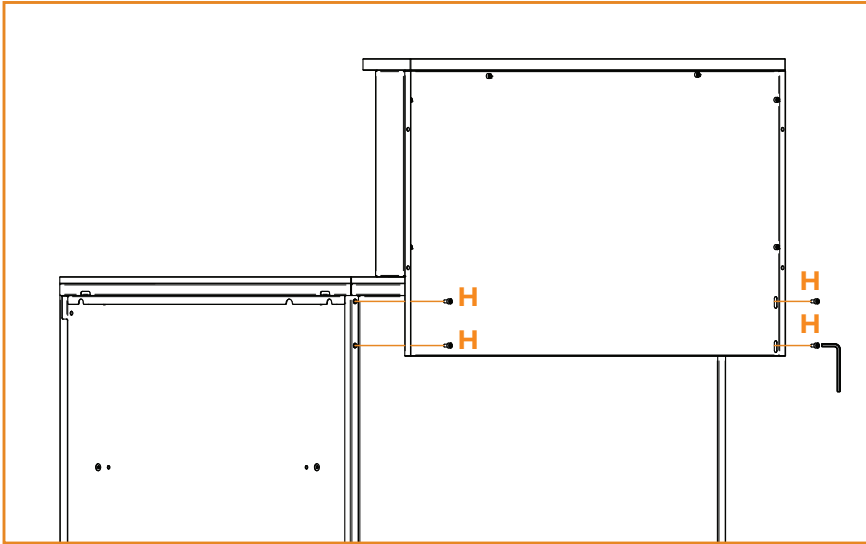

* Example image: WALL 90

Leg Adjustment Screw

There are four visible orifices on top of the bottom plate of every module. Inside you can see the leg regulation screw. Use an Allen wrench to set all the legs until the module is settled and has proper leveling. Must be done with the module positioned in its definitive location.

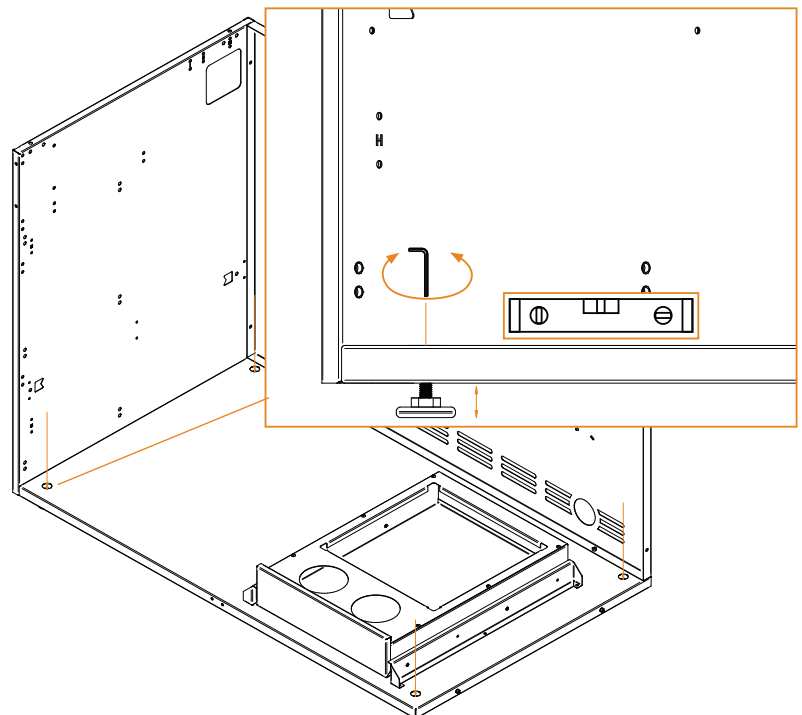

* Example image: MODULE LUMEN 6

Module to Module Assembly Step 01:

Use **M6X16 Button Head Screw (I - 4X)** to install spacer cylinders **M6x35 (J - 4X)** in the places shown with an allen wrench (or hex head). It is necessary to remove the drawers. ELYSIA Outdoor Modular Kitchen supplies extra M6X16 screws to ensure the user always have enough screws to assembly ELYSIA Outdoor Modular Kitchen.

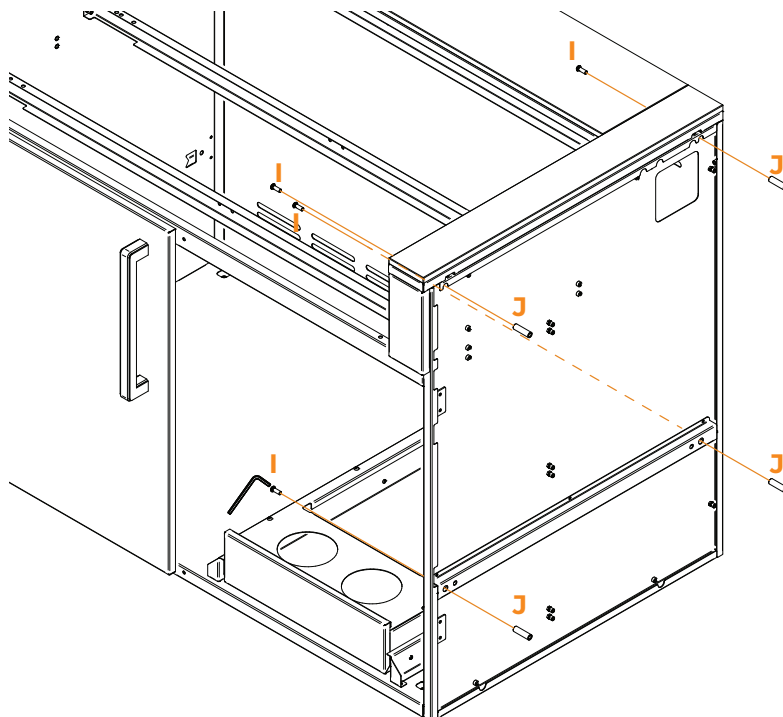

* Example image: MODULE LUMEN 6

Module to Module Assembly Step 02:

Use **M6X16 Button Head Screw (I - 4X)** to assembly one module to another, screwing the bolts to previous installed **spacer cylinders (J)** in the first module (shown left in the image) from the inside of the second module (shown right in the image).

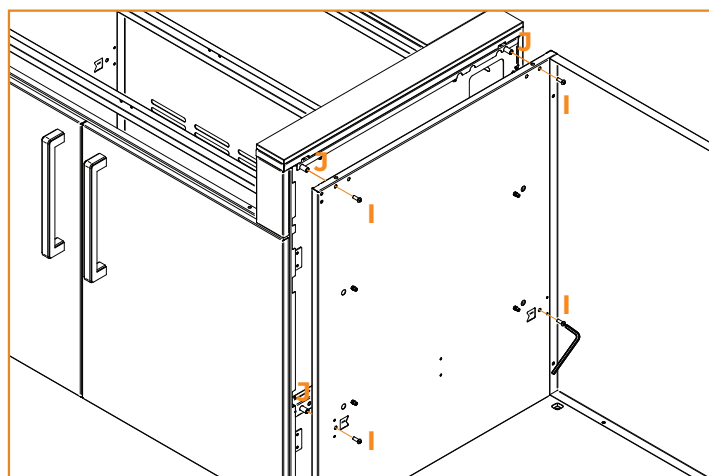
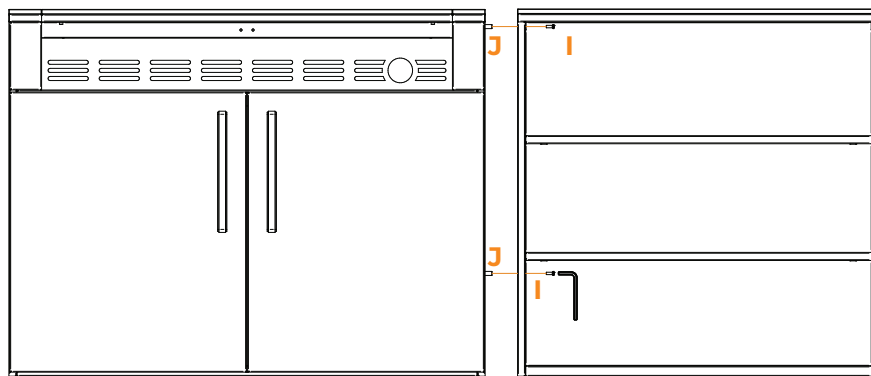

* Example image: MODULE LUMEN 6 / STORAGE 90

Module Countertop Adjustment

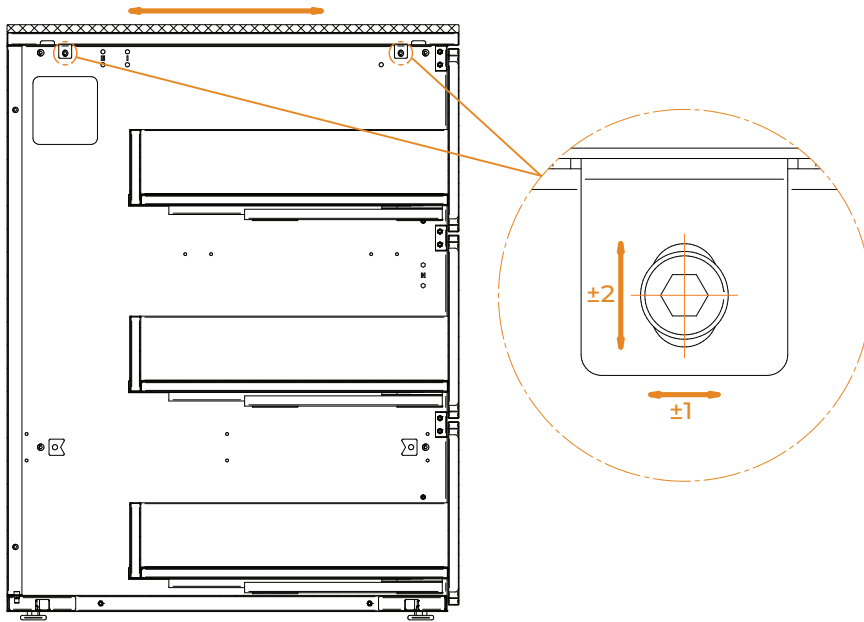

Adjust the countertops until they are level.

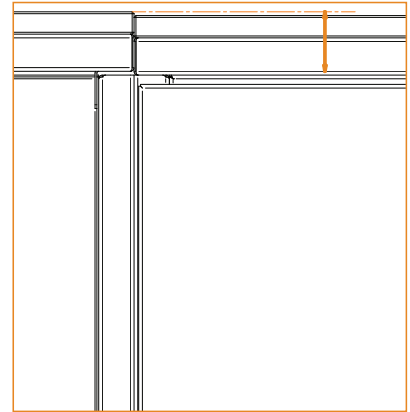

Tolerance Range for Wall Adjustment

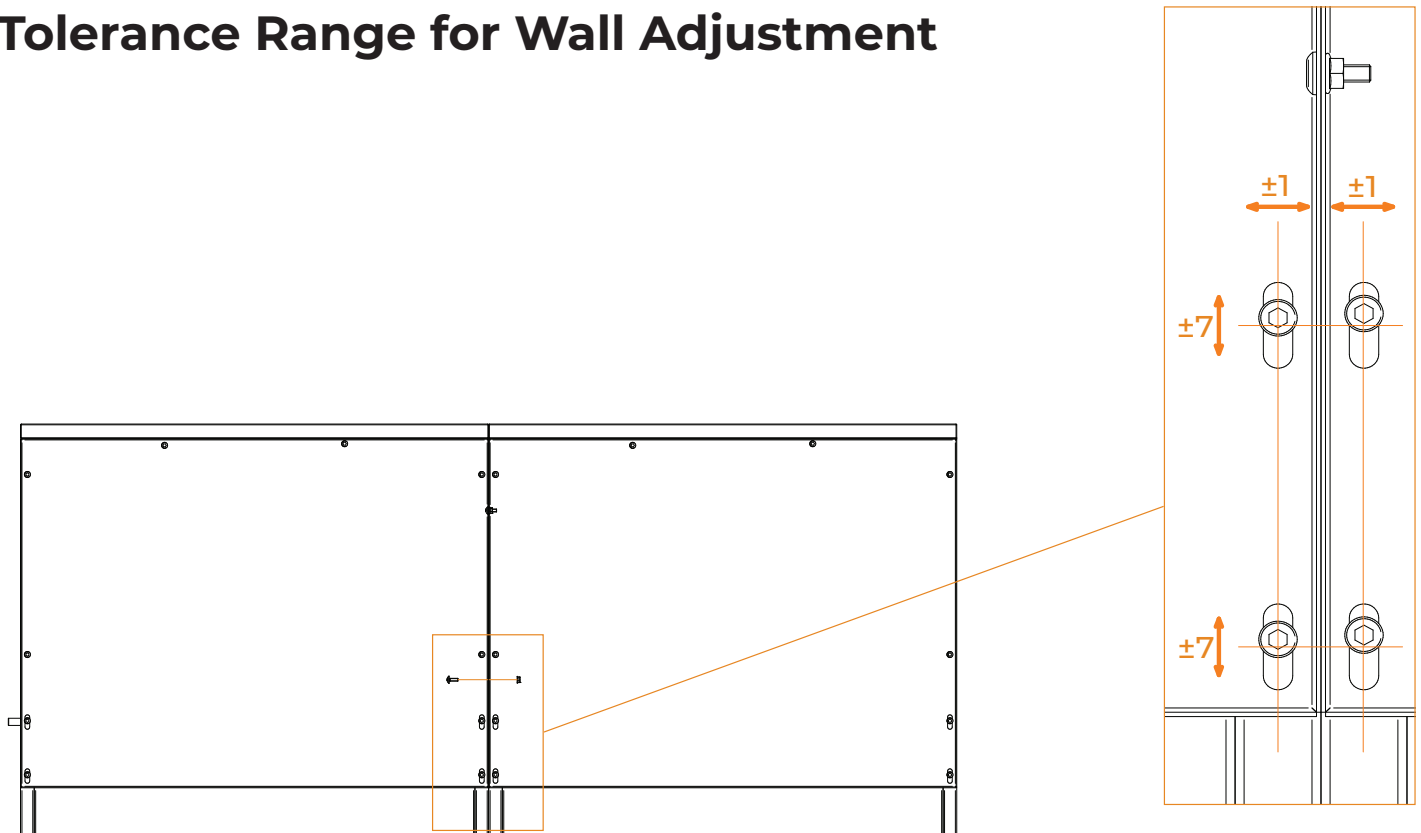

* Example image: WALL 65

End Panels / Kamado End Panels:

Place the **M6X15 hexagonal spacers (i)** along with their **washers** in the indicated locations, and secure them with the **M6 nuts (ii - 4 pcs on End Panels 1, 2 pcs on Kamado End Panels 2)**.

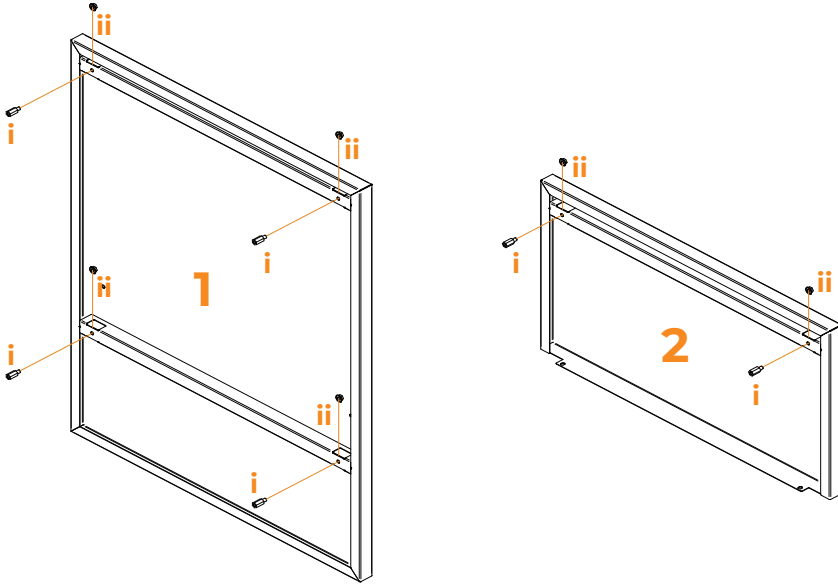

* Example image: END PANEL / KAMADO END PANEL

End Panel Mountage:

Use **M6X10 screws (iii - 4pcs)** to install the **End Panel** to the side of the module with an allen wrench (or hex head). It is necessary to remove drawers to screw inside screws if module has any.

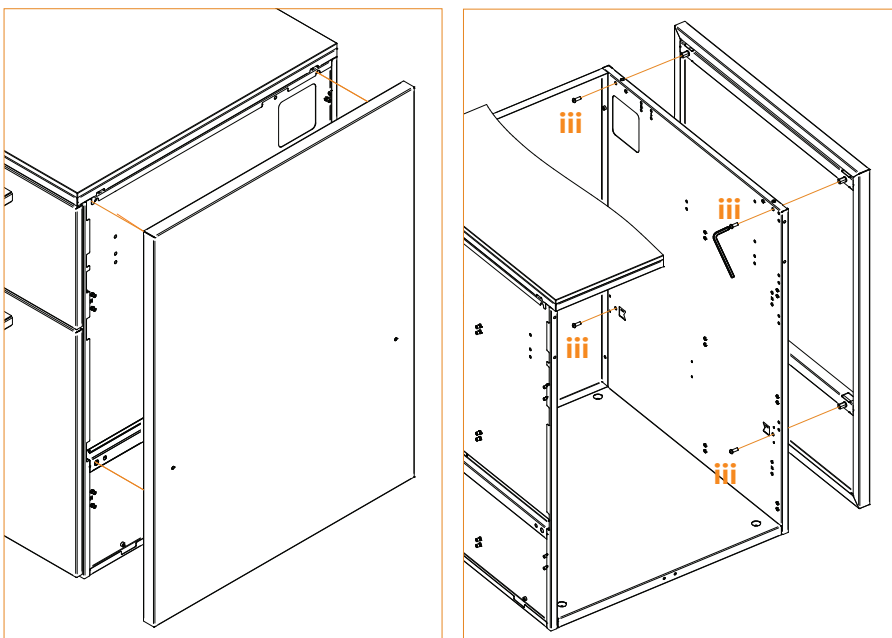

* Example image: STORAGE 65

Handles Assembly:

Use **M4x12 bolt (E - 2X per handle supplied)** to assemble the handles to module doors or drawers front plate.

Handles Available



Black Handle



Stainless Steel Handle

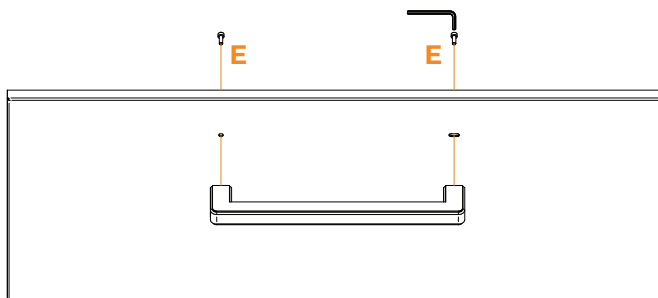
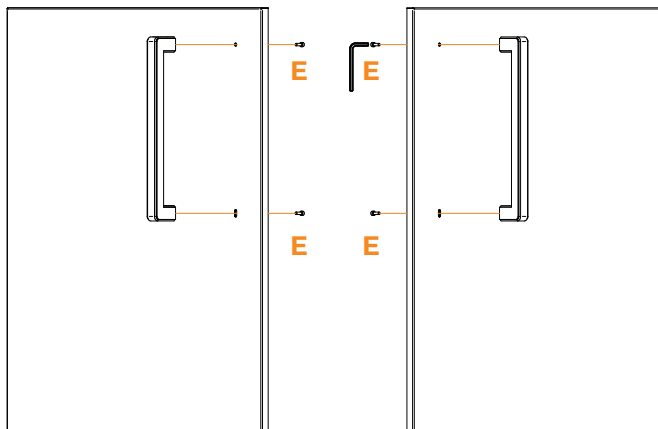

* Example image: MODULE LUME 6 / MODULE KAMADO

Gas Tank Placement:

ELYSIA Outdoor Modular Kitchen appliance modules count with a tank tray where gas tank is placed. Tank tray can be dragged out when placing the tank for the user's comfort.

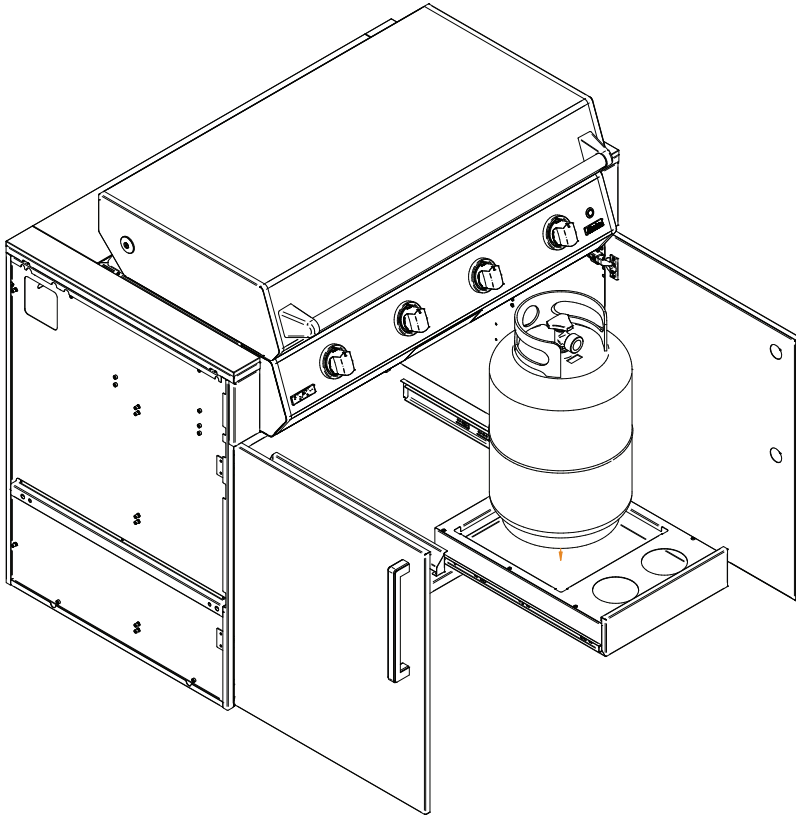

Door Hinge Adjustment:

The door hinges can be regulated by using a screwdriver. The screw located in the bearing of the hinge can be used to adjust height, the screw located near the cup is used for side adjustment and the one farthest from the cup is used to adjust depth.

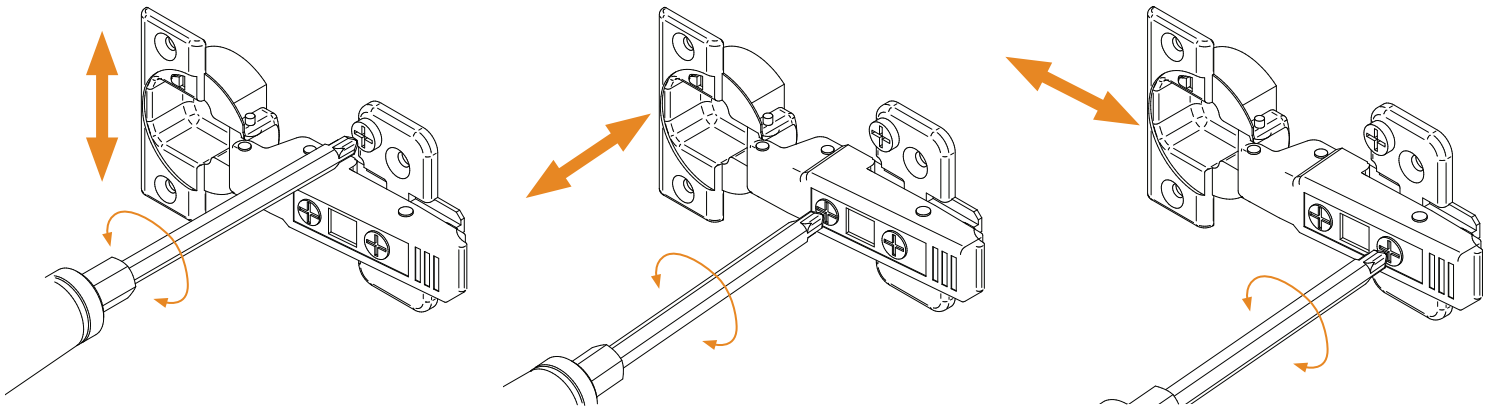

To prolong the life of your ELYSIA Outdoor Modular Kitchen please follow the recommended maintenance instructions:

Powder Coated Surfaces

Scheduled cleaning will benefit and extend the long lasting aesthetics of the finish. This procedure is an integral part of the warranty given for surface finish and color retention and it will minimize the weathering effect of dirt and other airborne pollutants which tend to accumulate on the surface of the coating, dulling its appearance. We suggest the following guidelines:

- Cleaning of the coated surfaces with warm water and mild detergent or non abrasive pH-banaced cleaner solution, and the use of non abrasive brush or sponge.
- The cleaning solution should not be allowed to be in contact with the powder coated surface for more than 30 minutes.
- DO NOT use any chlorides or quaternary salts on the module. DO NOT use any hydrochloric acid (muriatic acid) on modules. Refrain from using harsh chemicals, solvents, or abrasive cleaners, as they can damage the powder coating. Opt for cleaners specifically designed for powder-coated surfaces.
- After cleaning, the surface shall be completely rinsed-off with clean fresh water to remove any cleaning residue. This helps prevent the accumulation of cleaning agents that might affect the powder coating over time.
- A record of all cleaning schedules, frequencies and products should be kept and documented.
- While cleaning is crucial, avoid using high-pressure washers, as the force can damage the powder coating. Stick to gentle cleaning methods to ensure the longevity of the finish.

Hard water deposits can affect the appearance of the powder coating over time. When the outdoor kitchen is not in use, consider using protective covers to shield it from the elements. This helps prevent exposure to harsh sunlight, rain, and other environmental factors that could impact the powder coating. If your area has hard water, consider wiping down the surfaces after rain or watering to prevent water spots.

Neolith Stone Maintenance

Please take extra care when cleaning your top Neolith stone. Although solvents, such as acetone, are often recommended by counter manufacturers and fabricators, these substances your ELYSIA Outdoor Modular Kitchen powder coated finish.

To clean your countertop stone, use soapy water and a damp cloth. If there are stains encrusted/dry, you have to soak the stain with a standard detergent and wait to rub with a damp cloth.

Special consideration with ceramic knives which may scratch Neolith's surface in every finish.

PAGE INTENTIONALLY LEFT BLANK

ELYSIA

OUTDOOR MODULAR KITCHEN BY **FONTANA**
F O R N I

877.842.9822 | support@fontanaovens.com | FontanaOvens.com